

# Informed and **51st Annual Scientific Meeting of SAPC** 18-20 July 2023 inclusive primary care

Hilton Brighton Metropole Hotel | Hosted by Brighton & Sussex Medical School



PROGRAMME



Email: [office@sapc.ac.uk](mailto:office@sapc.ac.uk) | web: [sapc.ac.uk](http://sapc.ac.uk) | Twitter: [@sapcacuk](https://twitter.com/sapcacuk) #sapcasm

# ASM Conference Committee

---

Chair: *Duncan Shrewsbury*

Scientific Programme Chair: *Eduard Shantsila*

Marina Boulton

Emily Fletcher

Samuel Freeman

Kerstin Nothnagel

Philip Rankin

## ORGANISERS

Charlotte Cartledge & Katie Trace - SAPC

## DESIGNER

Mark Orriss ([www.orriss-design.co.uk](http://www.orriss-design.co.uk))  
Graphic design for the conference

---

### Stay hydrated!

Water dispensers will be available in all meeting rooms and disposable cups provided. However, to reduce waste all attendees are encouraged to bring along their own reusable water bottle.

## ELECTRONIC PROGRAMME AND ABSTRACTS



Abstracts can be found on the SAPC website by clicking on individual presentations in the parallel sessions: [www.sapc.ac.uk/conference/2023#schedule](http://www.sapc.ac.uk/conference/2023#schedule)

Create your own personal programme of talks within parallel sessions following these steps:

Visit [www.sapc.ac.uk/conference/2023#schedule](http://www.sapc.ac.uk/conference/2023#schedule)

- Scroll up a line so that SCHEDULE is visible on the left of the page and tabs on the right for all sessions and my sessions - start in "all sessions" mode.
- the talks shown in the grey shaded areas can be selected by clicking on the grey star (top right of the talk title). When you click the grey star it will turn red. Once you have finished selecting click on the "my sessions" tab at the top of the schedule - then just the sessions you have selected will be displayed.
- To save your selection copy and paste the URL into a fresh tab and save it to favourites.
- You can return to the "all sessions" tab to view all the talks.

*Abstracts can be viewed by clicking on the "full abstract" below each talk.*

## ACCESSIBILITY

The Double Tree by Hilton Brighton Metropole is accessible to all. If you need any assistance or additional support please do not hesitate to ask one of the conference staff who will be pleased to help you.

# A VERY WARM WELCOME TO THE 51st SAPC ASM 2023

Hello! I am really excited to welcome you all to this year's annual scientific meeting, which we are hosting for the first time ever in Brighton. This is SAPC's second in-person conference since the restrictions necessitated by the covid-19 pandemic have been lifted, and we hope to make it a very special and memorable experience for all.

The theme of the conference this year is ***Informed and Inclusive Primary Care***. Recent years have seen the gap between the least and most well-off in society widen, and this is reflected in a wide range of metrics that illustrate the impact of this inequity in the health and social care space too.

This conference theme means that we can look forward to some incredible, engaging and inspiring plenary sessions that will orientate us towards a deeper consideration of health inequalities, and how our work might address these. We have a stellar line-up of speakers and presenters who will showcase work in this domain. The main conference will then launch with a welcome address and novel plenary on Wednesday morning. We will look forward to a diverse range of parallel sessions showcasing work that colleagues across the academic primary care spectrum are engaging in and have an exciting seaside Conference Celebration planned for the Wednesday evening. The second day of the conference will begin with a second welcome and opening, with this year's Helen Lester Memorial Lecture, which will then be followed by another range of parallel sessions. Thursday will also see our prizes, joint awards and annual general



meeting (AGM) being brought centre-stage in the middle of the day. The whole event promises to combine a celebration and sharing of the great work that our community does, whilst also platforming, front-and-centre, the very reason our work is so necessary.

This year sees the return of the Picture Competition - so don't forget to upload any snaps you take during the conference to social media tagging #SAPC2023. The winner will be selected at the end of the conference and presented with a prize of a BSMS / University of Brighton hoodie, alongside the winners of the other conference award categories.

Following from the theme of inclusion, we want to welcome and support people with a Wellbeing Room for anyone who needs some quiet time away from crowds, a traffic light system to signal level of comfort with different interactions (respecting space, handshakes or hugs) in the hope this will mitigate concerns about covid, and inclusive facilities, such as all-gender inclusive toilets, and the provision of pronoun badges to add to your conference lanyard.

*Duncan*

Dr Duncan Shrewsbury (they/them)  
Reader in Clinical Education & Primary Care, BSMS  
Conference chair

# CONTENTS

Programme	Pg 6
Keynote speakers	Pg 16
Community groups	Pg 17
Posters	Pg 18
Social programme	Pg 22
Conference information	Pg 23
Exhibitors	Pg 24
Peer reviewers	Pg 25
Map of conference venue	Back cover

## PROGRAMME AT A GLANCE

Conference venue DoubleTree by Hilton at Brighton Metropole. Speaker preview is in Office 2.

### TUESDAY 18TH JULY 2023

9:30-12:30	Education SIG Meeting	Ambassador
12:00-13:30	SAPC Exec Meeting	Osbourne
12:30-18:00	HoTs Meeting	Ambassador
14:00-17:00	HoDs Meeting	Osbourne
14:30-17:00	Mackenzie Group Meeting	Surrey 2
15:00-18:00	SIG Café	Oxford
	Refreshments available throughout. SIGs are welcome to network and mingle throughout this session with dedicated times and tables allocated to the below SIGs: 15:00 - 16:00 Multi-morbidity, Palliative 16:00 - 17:00 Meds optimisation, QASI 17:00 - 18:00 CVD, Digital, PPI, Womens Health, Mental Health	

# PROGRAMME AT A GLANCE

## WEDNESDAY 19TH JULY 2023

8:00	Registration opens	Sussex Lounge
9:00-10:45	WELCOME AND PLENARY 1 Welcome from Duncan Shrewsbury, ASM Chair Plenary 1: <b>Becks Fisher</b> Senior Policy Fellow, The Health Foundation Community Group Showcase	Oxford
10:45-11:30	Refreshment break	
11:30-12:30	Parallel sessions 1A-F (See programme pages)	
12:30-14:00	Lunch & ePosters 6A-E viewing and discussion	Durham
14:00-15:30	Parallel sessions 2A-F (See programme pages)	
15:30-16:00	Refreshment break and SAPC Ambassador Meet & Greet	Durham
16:00-17:00	Parallel sessions 3A-F (See programme pages)	
19:30-23:30	ASM Celebration dinner	i360

## THURSDAY 20TH JULY 2023

7:40-8:40	PHoCuS meeting (Primary Healthcare Scientists)	Surrey 2
8:00	Registration opens	Sussex Lounge
8:45-10:45	WELCOME	Oxford
9:00	The 9th Helen Lester Memorial Lecture <b>Andrea Williamson</b> Professor of General Practice and Inclusion Health, University of Glasgow	
9:45	Distinguished papers from the annual meetings of Australasia & USA Australasian Association of Academic Primary Care (AAAPC) <b>Rhea Singh</b> General practitioner experiences in delivering early medical abortion services to women from culturally and linguistically diverse backgrounds	
10:00	North American Primary Care Research Group (NAPCRG) <b>Marije te Winkel</b> Personal Continuity and Prescribing Correctly: a Perfect Couple in Primary Care	
10:15-10:45	SAPC Annual General Meeting	Oxford
10:45-11:15	Refreshment break	Durham
11:15-12:45	Parallel sessions 4A-F (See programme pages)	
12:45-14:00	Lunch & ePosters 7A-E viewing and discussion	Durham
14:00-15:30	Parallel sessions 5A-F (See programme pages)	
15:30-16:00	Refreshment break	Durham
16:00	AWARD WINNERS SESSION Chairs Rupert Payne and Eduard Shantsila	Oxford
16:05-16:20	SAPC/RCGP Elective prizewinner 2022 <b>Ioan Wardhaugh</b> <i>GP Workforce Recruitment and Retention in Welsh Coastal Communities - what can be done to stem the tide?</i>	
16:20-16:30	SAPC Doctoral prizewinner presentation - <b>Sarah Mills</b>	
16:30-17:00	SAPC ASM 2023 Distinguished Paper presentations	
16:30-16:45	<b>Richard Baker</b> Do general practices in England influence life expectancy?	
16:45-17:00	<b>Carol Bryce</b> The hidden work of engaging with online services: ethnographic case study on digital facilitation	
17:00	SAPC ASM prize giving session	
17:10	Closing remarks ASM 2024 Bristol	
17:30	Conference closes	

## TUESDAY 18TH JULY

TIME	LOCATION
9:30-12:30	Ambassador
12:00-13:30	Osbourne
12:30-18:00	Ambassador
14:00-17:00	Osbourne
14:30-17:00	Surrey 2
15:00-18:00	Oxford
15:00 -16:00	
16:00 -17:00	
17:00 -18:00	

Education SIG meeting  
SAPC Exec meeting  
HoTs meeting  
HoDs meeting  
Mackenzie Group meeting  
SIG Café - SIGs are welcome to network and mingle throughout this session with dedicated times and tables allocated to the below SIGs:  
Multi-morbidity, Palliative  
Meds optimisation, OASI  
CVD, Digital, PPI, Womens Health, Mental Health

## WEDNESDAY 19TH JULY

TIME	LOCATION
8:00	Sussex Lounge
9:00-10:45	Oxford
10:45-11:30	Durham
11:30-12:30	
11:30	
11:40	

Registration opens  
WELCOME AND PLENARY 1  
Welcome from Duncan Shrewsbury, ASM Chair  
Plenary 1 : Becks Fisher Senior Policy Fellow, The Health Foundation  
Community Group Showcase  
Refreshment break  
Parallel sessions 1A-F

TIME	1A Inequalities Room: OXFORD Chairs: <i>Caroline Mitchell &amp; Ludvine Garside</i>	1B Antibiotics and Infections Room: KENSINGTON Chairs: <i>Rupert Payne &amp; Samuel Freeman</i>	1C Digital Impact Room: CAMBRIDGE Chairs: <i>Rachel Spencer &amp; Carol Bryce</i>	1D Mental Health Room: CLARENCE Chairs: <i>Carolyn Chew-Graham &amp; Tom Kingstone</i>	1E Consultations & Workforce Room: LANCASTER Chairs: <i>Joanne Reeve &amp; Judith Ibbison</i>	1F Workshop Room: DURHAM BALCONY
11:30	1A.1 Responses to the inverse care law in Scotland over the past 20 years: a qualitative study. <i>Alessio Albanese</i>	1B.1 Can digital health interventions assist with patient support in primary care settings?: Exploring enablers and barriers. <i>Mel Ramasawmy</i>	1C.1 Can digital health interventions assist with patient support in primary care settings?: Exploring enablers and barriers. <i>Mel Ramasawmy</i>	1D.1 Intersection of ethnicity and physical multimorbidity on incidence of mental health conditions – retrospective cohort study from superdiverse south London. <i>Jamie Scuffell</i>	1E.1 What is the perceived impact of paramedics working in primary care teams on the working practices of other professionals in primary care and the experiences of patients? <i>Georgette Eaton</i>	1F.1 Overcoming challenges and facilitating research in Multiple Long-term Conditions. <i>Dr Jane Masoli</i>
11:40	1A.2 Do general practices in England influence life expectancy? <i>Richard H. Baker</i>	1B.2 Reducing Antibiotic Resistance in urinary tract infection in the practice - a randomised controlled trial. <i>Ildiko Gagyor</i>	1C.2 How are staff and patients supported to access and use digital services in primary care? Interview study with stakeholders. <i>Dr Bethan Treadgold</i>	1D.2 Patient-reported outcome measures for monitoring depression in primary care: cluster randomised controlled trial. <i>Tony Kendrick</i>	1E.2 Supporting and retaining new to practice GPs through training in advanced generalist medicine: An evaluation of the Catalyst programme. <i>Myriam Dell'Olio</i>	

11.50	1A.3 What are the experiences and needs of Perimenopause in Bristol's Black Communities? <b>Jo Burgin</b>	1B.3 Point-of-care testing in care homes: a qualitative interview study with UK care home staff. <b>Abi Moore</b>	1C.3 What are the differences between telephone and face-to-face consultations when discussing emotional symptoms/concerns? Findings from a mixed methods qualitative study. <b>Catherine Woods</b>	1D.3 How can service users and practitioners collaborate to optimise medication in people living with severe mental illness (SMI)? <b>Ian Maidment</b>	1E.3 Developing a Framework for 'Community Paramedicine' in Ireland. <b>Tomas Barry</b>	
12.00	1A.4 How do the public, health care professionals, and policy makers view unhealthy behaviours in the context of socioeconomic deprivation? A qualitative study. <b>Hamish Foster</b>	1B.4 Knowledge and attitude factors influencing primary care clinicians' diagnosis, treatment, and management of urinary tract infections in England: A qualitative 'think-aloud' study. <b>Angela Kabulo Mwape</b>	1C.4 Going digital: evolution of the general practice receptionist role. <b>Stephanie Stockwell</b>	1D.4 Improving GP delivered cross-cultural mental health care: A qualitative study. <b>Aaron Poppleton</b>	1E.4 How do components of social connection interact in their associations with all-cause and CVD mortality? A UK Biobank cohort analysis. <b>Hamish Foster</b>	
12.10	1A.5 Providing care to marginalised communities: a qualitative study of community pharmacy teams. <b>Kelly Howells</b>	1B.5 Patients' experiences and views of recurrent urinary tract infections: qualitative evidence synthesis and meta-ethnography. <b>Leigh Sanyaulu</b>	1C.5 Di-Facto patient survey: Digital facilitation to support patient access to online services in primary care. <b>Gary Abel</b>	1D.5 Community Outpatient Psychotherapy Engagement Service for Self-harm (COPESS): A feasibility trial. <b>Pooja Saini</b>	1E.5 Recognising health inequalities within the Additional Roles Reimbursement Scheme in primary care. <b>Nicola Walsh</b>	
12.20	1A.6 Bridging Gaps: Improving access to primary care for and with marginalised patients- "It's quite joyful for us. It's really improved our work" <b>Lucy Potter</b>	1B.6 What are the knowledge, needs, and practices of GPs in the diagnosis and management of urinary tract infections? <b>Eefje de Bont</b>	1C.6 Exploring perceptions about the potential deployment of Artificial Intelligence within the English NHS Diabetic Eye Screening Programme. <b>Lakshmi Chandrasekaran</b>	1D.6 Are there gender-based mental health inequalities in primary care in England? <b>Ruth Watkinson</b>	1E.6 Being boundaried: The costs of saying no and the costs of saying yes. <b>Dr Rachel Barnard</b>	
12.30-14.00	Lunch & ePosters 6 Stations A-E viewing and discussion					<b>Durham</b>
	<b>6A ePoster discussion - Cancer</b> Room: DURHAM TERMINAL 1 <i>Chair: Nada Khan</i>	<b>6B ePoster discussion - Child &amp; Young Peoples Health</b> Room: DURHAM TERMINAL 2 <i>Chair: Rosina Cross</i>	<b>6C eposter discussion - Inequalities</b> Room: DURHAM TERMINAL 3 <i>Chair: Philip Rankin</i>	<b>6D eposter discussion - Research Methods</b> Room: DURHAM TERMINAL 4 <i>Chair: Edward Shantsila</i>	<b>6E ePoster discussion - Consultations &amp; Workforce</b> Room: DURHAM TERMINAL 5 <i>Chair: Emily Fletcher</i>	
13.00	6A.1 Developing and Validating a Multivariable Lung Cancer Risk Prediction Model that identifies high-risk smokers in areas with a higher incidence of disease: ECLS and UK Biobank. <b>Lamona Brown</b>	6B.1 Does dietary advice based on food allergy tests improve disease control in children with eczema? Trial of food allergy IgE tests for Eczema Relief (TIGER) study protocol. <b>Catherine Woods</b>	6C.2 The under-representation of minority ethnic groups in academic general practice. <b>Alice Howe</b>	6D.2 The Measurement of Treatment Burden after Stroke (TRUSTED). <b>Frances Mair</b>	6E.1 Do single-handed and single-partnered practices deliver high-quality personalised care? <b>Ian Holdroyd</b>	
13.10	6A.2 The effect of multimorbidity on diagnostic interval for lung cancer and mesothelioma: a cohort study using data from the Clinical Practice Research Data link. <b>Imogen Rogers</b>	6B.2 What is the relationship between socio-economic factors and self-reported health in adolescents? <b>Frank Sullivan</b>	6C.3 What barriers exist in delivering healthcare to Indigenous people living with multimorbidity in settler-colonies and how can culturally appropriate care improve outcomes: a narrative review of aetiology and management. <b>Dr Harm Van Marwijk</b>	6D.3 A SYSTEMATIC REVIEW OF THE USE OF BURDEN OF TREATMENT THEORY. <b>Frances Mair</b>	6E.2 The uptake of roles through the Additional Roles Reimbursement Scheme and associations with patient experience: Analysis of General Practices and Primary Care Networks in England 2020-2022. <b>Chris Penfold</b>	
13.20	6A.3 'Picking up the pieces' - primary care practitioners' experiences of cancer care reviews: a qualitative study. <b>Dipesh Gopal</b>				6E.3 Navigating the boundaries of identity when GPs work with the public outside of the consultation. A qualitative participatory action research study. <b>Jessica Drinkwater</b>	

13.30	6A.4 Can community pharmacies help to reduce health inequalities in early cancer detection? <b>Judit Konya</b>	6B.4 Young people's priorities for the self-management of distress after stoma surgery due to inflammatory bowel disease: a consensus study using online nominal group technique. <b>Benjamin Saunders</b>	6C.4 Barriers to healthcare faced by people with a learning disability from ethnic minority populations: unpicking the effects of COVID-19. <b>Christina Roberts</b>	6D.4 The Acceptability of Quantum-Inspired Imaging for Remote Monitoring of Health & Disease in Community Healthcare (QUEST). <b>Karen Wood</b>	6E.4 Operational failures in general practice (OFIG): A consensus-building study of the operational failures on GPs' and patients' priorities for improvement. <b>Ahmed Alboksmaty</b>
13.40	6A.5 Socioeconomic Inequalities in the Diagnosis and Treatment of Ovarian Cancer in the United Kingdom: A Systematic Review and Narrative Synthesis. <b>Benjamin Pickwell-Smith</b>	6B.5 Holistic health and social care outreach for people experiencing homelessness with recent non-fatal overdose: the Pharmacy Homeless Outreach Engagement Non-medical Independent prescribing Rx (PHOENIX after overdose) pilot randomised controlled trial. <b>Richard Lowrie</b>	6C.5 Experiences of HIV Pre-Exposure Prophylaxis (PrEP) users in Wales during the COVID-19 pandemic - A qualitative interview study. <b>Zahraa Khammas</b>	6D.5 Should researchers standardise usual care arms in randomised controlled trials? <b>Katrina Turner</b>	6E.5 What is the relationship between research activity and quality of care in English general practice? A mixed methods study. <b>Peter Bower</b>
13.50	6A.6 Novel decision support intervention to support choice in cervical screening modality: SUCCEED or in-clinic or self-sampling for HPV: Supporting person-centred choice for cervical screening. <b>Dr Eleanor Clarke</b>	6B.6 Barriers to healthcare for people with a learning disability from ethnic minority backgrounds: perspectives of self-advocates and carers. <b>Katie Umpleby</b>	6C.6 Research Methods Room: CAMBRIDGE Chairs: <i>Joe Rosenthal &amp; Kerstin Nothnagel</i>	6D.6 The Beauty and health community LOUNGE (BELONG) study: overview and preliminary findings. <b>Marjorie Lima do Vale</b>	
14.00-15.30	Parallel sessions 2A-F				
14.00	2A Consultations & Workforce Room: OXFORD Chairs: <i>Lucy Potter &amp; Lucy Pocock</i>	2B Quality in Prescribing Room: KENSINGTON Chairs: <i>Jo Protheroe &amp; Penny Geer</i>	2C Care of Older Adults Room: CLARENCE Chairs: <i>Carolyn Chew-Graham &amp; Sam Freeman</i>	2E COVID-19 Room: LANCASTER Chairs: <i>Pippa Oakeshott &amp; Polly Duncan</i>	2F Workshop Room: DURHAM BALCONY
14.10	2A.1 What interventions have addressed the Inverse Care Law in general practice in Scotland over the last 20 years? A systematic scoping review. <b>James Bogie/Cara Bezzina</b>	2B.1 Amitriptyline at Low-dose and Titrated for Irritable Bowel Syndrome as Second-line Treatment in Primary Care (The ATLANTIS study): A Double-blind Placebo-controlled Trial. <b>Hazel Everitt</b>	2D.1 How do older people with Multiple Long-Term Conditions engage with behaviour change interventions? A qualitative study. <b>Jessica Catchpole</b>	2E.1 "We figuring stuff out myself" - maternal vaccination uptake in socially and ethnically diverse areas in London in the Covid-19 context: a qualitative study. <b>Sima Berendes</b>	2F.1 Sexual healthcare for trans, non-binary and gender-diverse people. <b>Julia Bailey</b>
14.20	2A.2 A Realist Evaluation of the Clinical- and Cost-effectiveness of Paramedics Working in General Practice. <b>Matthew Booker</b>	2B.2 Low-dose amitriptyline for irritable bowel syndrome (IBS): patients' and GPs' views on barriers and facilitators of prescribing and uptake. <b>Emma Teasdale</b>	2D.2 Visualising and understanding post discharge management of older people in general practice. <b>Rachel Spencer</b>	2E.2 A longitudinal perspective on living with and accessing health-care for long-COVID in Scotland: a qualitative study. <b>Susan Browne</b>	
14.30	2A.3 How does continuity of care work when patients are seen outside their regular general practice? A theory based on two case studies of extended access providers. <b>Patrick Burch</b>	2B.3 Unblinding to treatment allocation in randomised placebo-controlled trials: A new process and analysis of patient perspectives from a trial of low-dose amitriptyline for irritable bowel syndrome (IBS) in primary care. <b>Felicity Bishop</b>	2D.3 Community-dwelling frail older people's views of frailty and frailty services: a qualitative study. <b>Catherine Aicken, Una Kerin</b>	2E.3 Research equity in the PRIN-CIPLE and PANORAMIC national community COVID-19 Clinical Trials. <b>Mahendra G Patel</b>	
14.30	2A.4 Access to General Practice: Which systems have been tried? - A Scoping Review. <b>Abi Eccles</b>	2B.4 A Cohort Study in the Clinical Practice Research Datalink to explore whether potentially inappropriate prescribing (PIP) in middle-aged adults is associated with increased healthcare utilisation and mortality. <b>Michael Naughton</b>	2D.4 What makes a multidisciplinary medication review and deprescribing intervention for older people work well in primary care? A realist review and synthesis. <b>Kinda Ibrahim</b>	2E.4 How do participants experience the work involved in the Remote Diet intervention to Reduce long-COVID symptoms Trial (ReDiet)? <b>Yvonne Cunningham</b>	



14.40	2A.5 How does equitable general practice look like? A realist review and action framework. <b>Anna Gkiouleka</b>	2B.5 Improving Medicines use in People with Polypharmacy in Primary Care (IMP3): Delivery of a multicentre cluster randomised trial evaluating a complex intervention for medication optimisation. <b>Rupert Payne</b>	2C.5 Learning from co-production methods to improve participation of people with learning disability from ethnic minority populations in healthcare research. <b>Nicola Cooper-Moss</b>	2D.5 A qualitative study of ambulance personnel, care staff and service users' experiences and perceptions of emergency care in care homes. <b>Despina Lapatidou</b>	2E.5 What is the underlying pathophysiology of Long Covid? <b>Prof Brendan Delaney</b>
14.50	2A.6 What is the impact of remote consultations on workload, work practices and staff wellbeing? A primary care qualitative interview study (RECON Study). <b>Jeremy Horwood</b>	2B.6 Exploring Polypharmacy: A Storytelling-Based Co-Design Approach to Creating Patient-Centred Solutions. <b>Alison Thomson</b>	2C.6 Can treatment burden be assessed in routine General Practice using a brief measure which is valid and reliable? <b>Anastasia Kovalenko</b>	2D.6 What are the challenges of delivering tailored care for sleep disturbance among community-dwelling people living with dementia or mild cognitive impairment? <b>Aidin Anyankhesal</b>	2E.6 Can themes be identified in United Kingdom Health Security Agency records of general practice COVID-19 case investigations to support minimisation of SARS-CoV-2 transmission? <b>Lorna Duncan</b>
15.00	2A.7 'It's not just about seeing patients as a GP': the need to acknowledge, make visible and allocate time for hidden work in general practice. <b>Dr Sharon Spooner</b>	2B.7 Interim findings from a multicentre pilot randomised controlled trial (RCT): Community Pharmacy Homeless Outreach Engagement Non-medical Independent prescribing Rx (Community Pharmacy PHOENIX). <b>Richard Lowrie</b>	2C.7 Does a practice-level educational intervention improve the timely assessment of adults with shingles? Cluster randomised trial with nested qualitative study. <b>Elizabeth Lovegrove</b>	2D.7 Supporting the management of mental health problems among older adults: Where does the Fire and Rescue Service fit in an integrated world? <b>Tamsin Fisher</b>	2E.7 How do patients view access to primary care since the start of the Covid-19 pandemic? A qualitative study. <b>Rebecca Goulding</b>
15.10	2A.8 What are the characteristics of effective 'research active' general practices from the perspective of staff, patients and stakeholders? <b>Peter Bower</b>	2B.8 Evaluating a social prescribing initiative to support international medical graduates. <b>Nicholas Broadwell</b>	2C.8 Tackling 'inverse representation' through trial, error and triumph across ten research case studies: reflective research practice and autoethnography in the Deep En. <b>Caroline Mitchell</b>	2D.8 Predictors of conveyance of care home residents to hospital by ambulance services for medical emergencies. <b>Aloysius Siriwardena</b>	2E.8 How well does a rapid multiplex diagnostic assay for SARS-CoV-2 and Influenza A/B perform in symptomatic patients in the community? <b>Gail Hayward</b>
15.20	2A.9 Determinants of lipid clinic referral and attendance in a multi-ethnic adult population in South London. <b>Aya Ayoub</b>	2B.9 Recruitment to Talking in Practice (TIP): Randomised controlled trial testing the effects of communication skills e-learning for primary care practitioners on patients' musculoskeletal pain and enablement. <b>Hazel Everitt</b>	2C.9 The Hard Evidence Play: A Process Evaluation of the Use of Creative Methods as a Tool for Research Dissemination. <b>Cat Papastavrou Brooks</b>	2D.9 Improving access to personalised care planning for people living with dementia: Findings from the PiDem feasibility and implementation study. <b>Emily Spencer &amp; Sarah Griffiths</b>	2E.9 Molnupiravir for early COVID-19 treatment in primary care: PANORAMIC platform trial. <b>Paul Little</b>
15.30-16.00	Refreshment break and SAPC Ambassador Meet & Greet				
16.00-17.00	Parallel sessions 3A-F				
	<b>3A Child &amp; Young Peoples Health</b> Room: OXFORD <i>Chairs: Benjamin Saunders &amp; Nada Khan</i>	<b>3B Mental Health</b> Room: KENSINGTON <i>Chairs: Katrina Turner &amp; Tamsin Fisher</i>	<b>3C Long Term Conditions</b> Room: CAMBRIDGE <i>Chairs: Pippa Oakeshott &amp; Judith Iblson</i>	<b>3D Research Methods</b> Room: CLARENCE <i>Chairs: Nefyn Williams &amp; Marina Boulton</i>	<b>3E Digital Impact</b> Room: LANCASTER <i>Chairs: Benjamin Jackson &amp; Myriam Dell'Olio</i>
16.00	3A.1 Dietary advice for children with eczema and possible food allergy: A Delphi consensus study. <b>Ludwina Garside</b>	3B.1 Health professionals views on discontinuation of long-term antidepressants: a systematic review and thematic synthesis. <b>Ellen Van Leeuwen</b>	3C.1 Digital first primary care for patients with multiple long-term conditions – the views of staff and stakeholders. <b>Jenny Newbould</b>	3D.1 Using the Primary Care Academic Collaborative to explore patient safety in actioning and communicating blood test results. <b>Jessica Watson</b>	3E.1 The hidden work of engaging with online services: ethnographic case study on digital facilitation. <b>Carol Bryce</b>
16.10	3A.2 Patient and Public Involvement in the development of an online intervention for young people with acne: novel approaches to reach underserved groups. <b>Mary Steele</b>	3B.2 Understanding the mental health and psychosocial experiences of asylum seekers', refugees' and undocumented migrants' and their journey to accessing health-care and social services. <b>Alessio Albanese</b>	3C.2 Interim findings from a pragmatic, multicentre pilot randomised controlled trial (RCT) of optimisation of prescribing by primary care pharmacists in patients with chronic obstructive pulmonary disease (COPD) and associated co-morbidities. <b>Richard Lowrie</b>	3D.2 A concept mapping approach to assess factors influencing the delivery of community-based safety interventions to prevent cardiovascular disease and breast cancer among ethnically diverse women in South London. <b>Dr Maham Zaman</b>	3E.2 Impact and experiences of offering HIV testing across a whole city population through primary care clusters and GP surgeries in the Texting 4 Testing (T4T) project. <b>David Gillespie</b>
	3F.1 Developing an LGBTQ+ INCLUDE Framework. <b>Adam DN Williams</b>				<b>3F Workshop</b> Room: DURHAM BALCONY
	<b>Durham</b>				

16.20	3A.3 What are parents' perceptions and experiences of help-seeking for common infant symptoms? A qualitative interview study. <b>Amy Dobson [1]</b>	3B.3 Developing inclusive approaches to multidimensional mental health assessment in UK primary care: A qualitative study and community outreach approach. <b>Adam Geraghty</b>	3C.3 Managing epilepsy in primary care. A qualitative study and logic model. <b>Charlotte Cotterill</b>	3D.3 A mixed-methods evaluation of urgent care delivered through telephone based digital triage. <b>Vanashree Sexton</b>	3E.3 Making sense of technology: Use and non-use of doctor-patient video consultations in Danish general practice. <b>Elle Luchau</b>	
16.30	3A.4 Long-term consequences of urinary tract infection in Childhood (LUCI): Electronic population-based cohort study. <b>Kathryn Hughes</b>	3B.4 How do patients with mental health diagnosis interact with online services at the general practice? A qualitative study. <b>Jo Parsons</b>	3C.4 Participatory Co-design of a novel website to improve GPs' understanding of the benefits and harms of treatments for long-term conditions. <b>Julian Treadwell</b>	3D.4 Equity, Diversity, and Inclusion (EDI) thinking in systematic reviews: the comparison of two tools for increasing the awareness and consideration of EDI in a systematic review of physical activity and heart failure. <b>Alyson Huntley</b>	3E.4 Ethnic inequities in the patterns of Personalised Care Adjustments for 'Informed Dissent' and 'Patient Unsuitable': A retrospective study using Clinical Practice Research Datalink. <b>Brenda Hayanga</b>	
16.40	3A.5 CHOOSE - Children and young people psychiatric diagnoses before and during the Covid-19 pandemic. <b>Carolyn Chew-Graham</b>	3B.5 Can we reduce the risk of relapse of depression in primary care? A mixed methods study. <b>Andrew Moriarty</b>	3C.5 Evaluating ethnic variations in the risk of infections presenting to primary and secondary care in people with pre-diabetes and type 2 diabetes: a matched cohort study. <b>Umar A R Chaudhry</b>	3D.5 Primary care research for all: two proof-of-concept studies using the Primary Care Academic Collaborative (PACT) network. <b>Polly Duncan</b>	3E.5 Digital facilitation in primary care, a focused ethnographic study of the experiences of staff, patients and stakeholders. <b>Jenny Newbould</b>	
16.50	3A.6 Does a data-enabled Quality Improvement programme improve timeliness and equity of childhood immunisations across North East London? Milena Marszalek <b>Riya Tiwari</b>	3B.6 What were Health Professionals' perspectives of antidepressant discontinuation during the REDUCE trial? <b>Hannah Bowers &amp; Riya Tiwari</b>	3C.6 Which long-term conditions benefit from exercise-based rehabilitation, and how are comorbidities considered? An overview of systematic reviews. <b>Grace Dibben</b>	3D.6 Adherence to statins and LDL-cholesterol control: a population-based study using primary care data. <b>Juan Carlos Bazo-Alvarez</b>	3E.6 The illusion of inclusion: digital transformation in general practice. <b>Jackie van Dael</b>	
19.30-23.30	ASM Celebration dinner					<b>Durham</b>

## THURSDAY 20TH JULY

TIME		LOCATION
7:40-8:40	PHoCuS meeting (Primary Healthcare Scientists)	<b>Surrey 2</b>
8:00	Registration opens	<b>Sussex Lounge</b>
8:45-10:45	WELCOME	<b>Oxford</b>
9:00	The 9th Helen Lester Memorial Lecture <b>Andrea Williamson</b> Professor of General Practice and Inclusion Health, University of Glasgow	
9:45	Distinguished papers from the annual meetings of Australasia & USA Australasian Association of Academic Primary Care (AAAAPC) <b>Rhea Singh</b> General practitioner experiences in delivering early medical abortion services to women from culturally and linguistically diverse backgrounds	
10:00	North American Primary Care Research Group (NAPCRG) <b>Marije te Winkel</b> Personal Continuity and Prescribing Correctly: a Perfect Couple in Primary Care	
10:15-10:45	SAPC Annual General Meeting	<b>Oxford</b>
10:45-11:15	Refreshment break	<b>Durham</b>
11:15-12:45	Parallel sessions 4A-F	

	4A Cancer Room: OXFORD Chairs: Hazel Everitt & Kinda Ibrahim	4B Child & Young People's Health Room: KENSINGTON Chairs: Philip Rankin & Tamsin Fisher	4C Consultations & Workforce Room: CAMBRIDGE Chairs: Victoria Izortziou-Brown & Jo Protheroe	4D Inequalities Room: CLARENCE Chairs: Sian-Lee Ewan & Marina Boulton	4E Priorities in Women's Health Room: LANCASTER Chairs: Joanne Reeve & Judith Konya	4F Workshop Room: DURHAM BALCONY
11.15	4A.1 Understanding the diagnostic timeliness of cancer patients with pre-existing morbidities: What do different methodological approaches tell us? Gary Abel	4B.1 Using a child's antibiotic history as a data-enabled brief intervention to optimise antibiotic prescribing. Oliver Van Hecke	4C.1 GP Workforce Sustainability to maximise effective and equitable patient care: a realist review of what works, for whom and in what circumstances? Sophie Park	4D.1 Perspectives on Contraception amongst Ethnic Minority Groups: A Qualitative Study. (Work in progress). Rebecca Mawson	4E.1 Developing inclusive support for socioeconomically deprived and ethnic minority women with gestational diabetes, to reduce the risk of subsequent type 2 diabetes. Amanda Moore	4F.1 Using primary care data for research purposes. Dr Sarah Rodgers
11.25	4A.2 Does residency (rural vs. urban) influence the uptake of cervical, breast and colorectal cancer screening in Scotland? Jamie Collins	4B.2 Developing Acne Care Online: early insights from developing a digital behaviour change intervention to support effective treatment of acne in young people. Rosie Essery	4C.2 How the changing role of the GP is impacting community palliative care: a qualitative interview study. Ianuka Palit	4D.2 Person Centred care: an untapped resource to increase patient capacity to manage multimorbidity in the context of poverty? Marianne McCallum	4E.2 Under pressure and under scrutiny: supporting women's health in general practice; a qualitative study. Sharon Dixon	
11.35	4A.3 Complexities in cancer diagnosis: An embedded qualitative intervention development study for the Think Cancer! trial on early diagnosis of cancer in primary care. Julia Hiscock	4B.3 Seasonal trends in antidepressant prescribing, depression, anxiety, and self-harm in adolescents and young adults: an open cohort study using UK primary care data. Ruth Jack	4C.3 What are the facilitators of, and barriers to, the communication of poor prognosis between secondary and primary care? A systematic review with narrative synthesis. Dr Lucy Pocock	4D.3 Expanding Burden of Treatment Theory in the context of multimorbidity and poverty: the importance of community and biography. Dr Marianne McCallum	4E.3 "This is an intimate, dark, shaming space": Lived experiences of urogynaecological symptoms and help-seeking. Abigail McNiven	
11.45	4A.4 Symptom attribution and clinical decision-making among general practitioners relating to lung cancer investigations for patients with pre-existing COPD: a vignette study. Lucy Mitchinson	4B.4 Creating a patient experience film to convey experiences and emotions of older people and their carers' interaction with general practice following discharge from hospital. Rachel Spencer	4C.4 Creating a patient experience film to convey experiences and emotions of older people and their carers' interaction with general practice following discharge from hospital. Rachel Spencer	4D.4 Integration of primary care and palliative care services to improve cultural competency and equity at the end-of-life: Findings from realist stakeholder workshops. Sarah Mitchell	4E.4 In what ways can GPs improve care for Women with Anal Incontinence due to Childbirth Injury? Abi Eccles	
11.55	4A.5 Can incorporating lower risk symptoms into urgent cancer referral guidance detect cancers earlier? Sarah F. Moore	4B.5 TRAINS: a pragmatic cluster RCT to prevent summer holiday drop in asthma prescription uptake in school-age children. Rami Alyami	4C.5 A survey of patients' experiences of GP consultations since the introduction of the new GP contract in Scotland. Kieran Sweeney	4D.5 What is the prevalence of multimorbidity in migrants, refugees, asylum seekers and displaced persons and its association with mortality? Findings from a systematic review. Catherine O'Donnell	4E.5 Effectiveness of recruitment strategies to increase diversity within one trial site in a post-partum weight management intervention: the Supporting Mum's Randomised Controlled Trial. Alice Ivoy & Emmanuela Osei-Asemani	
12.05	4A.6 The ThinkCancer! Intervention: results and lessons learned from a phase II feasibility trial in Wales. Annie Hendry	4B.6 Healthcare professionals' priorities for training to identify and manage distress experienced by young people with a stoma due to inflammatory bowel disease: a consensus study using online nominal group technique. Benjamin Saunders	4C.6 How are social prescribing link workers creating and maintaining professional networks in different socioeconomic areas? Amadea Turk	4D.6 FAIRSTEPS: integrative Review of the Barriers and Enablers to Primary Care Equity Josephine. M.K. Reynolds	4E.6 In delicate condition: A scoping review on insights to promoting uptake of antenatal vaccination. Stephanie McCarron	
12.15	4A.7 What is the risk of cancer after a negative urgent suspected cancer referral? Suzanne Scott	4B.7 Accuracy of the LqSOFA and National PEWS scores for detecting serious illness in acutely unwell children presenting to general practice. Kathryn Hughes	4C.7 The Experiences of Patients with Palliative Care needs and their Carers who have accessed Out-of-Hours Care in the Community: A Systematic Review. Mark Walker	4D.7 A co-produced systematic review about barriers to healthcare in people with a learning disability from ethnic minority populations. Christina Roberts	4E.7 A systematic review to identify the optimum implementation for HPV self-sampling in underserved communities. Olivia Mackay	



14.00-15.30		Parallel sessions 5A-F					
		<p><b>5A Quality in Prescribing</b> Room: OXFORD Chairs: <i>Rupert Payne &amp; Kerstin Notnagel</i></p> <p>5A.1 What are the challenges / barriers for GPs in prescribing cardio-protective medication to patients with severe mental illness (schizophrenia, bipolar disorder, major depression)? A qualitative study in Edinburgh and Glasgow health board areas. <b>Dr Amanda Vettini</b></p> <p>5A.2 Greener Asthma Prescribing Study: A qualitative study exploring healthcare professional perspectives on reducing the prescribing of metered dose inhalers for asthma to reduce the carbon footprint of primary care. <b>Lauren Franklin</b></p> <p>5A.3 Prescription medication sharing in England: A population-based telephone survey. <b>Dr Deborah McCahon</b></p> <p>5A.4 Prescribing selective serotonin reuptake inhibitors (SSRIs) for women of reproductive age, during pregnancy or breastfeeding: a systematic review of local formulary guidance in England and Wales. <b>Elizabeth Lovegrove</b></p> <p>5A.5 Formation of primary care networks and changes in prescribing of overprescribed medications associated with health inequalities: an observational study and time series analysis. <b>Dr Tasneem Khan</b></p> <p>5A.6 Prescription medication sharing for non-recreational purposes: A systematic review of the literature. <b>Shoba Dawson</b></p>	<p><b>5B Prevention &amp; Risk</b> Room: KENSINGTON Chairs: <i>Chris Burton &amp; Rebecca Mawson</i></p> <p>5B.1 How can we make care for people at risk of multimorbidity more inclusive?: Findings from the SYMPHONI study. <b>Carolyn Chew-Graham</b></p> <p>5B.2 Understanding measurement of postural hypotension: a nationwide survey of primary care practice in England. <b>Sinead TJ McDonagh</b></p> <p>5B.3 Understanding Measurement of Postural Hypotension in Primary Care – A qualitative approach. <b>Rosina Cross</b></p> <p>5B.4 Skin Lesions Made Easy: A Case Study on Using Participatory Approaches to Include Patients, Clinicians, and Members of the Public to Improve Dermatology Referrals. <b>Laura Alvarado Cruz</b></p> <p>5B.5 Consequences of Over-Diagnosing Hypothyroidism in an Ageing United Kingdom population (CODHA UK). <b>Mia Holley</b></p> <p>5B.6 Incident dementia risk among patients with type 2 diabetes receiving metformin versus alternative antihyperglycaemic agents: a retrospective cohort study using UK primary healthcare records. <b>William Doran (1)</b></p>	<p><b>5C Long Term Conditions</b> Room: CAMBRIDGE Chairs: <i>Nefyn Williams &amp; Sarah Moore</i></p> <p>5C.1 What does “housebound” mean? <b>Polly Duncan</b></p> <p>5C.2 A scoping review on multimorbidity clustering and its effect on treatment burden and the utilisation of health and social care services in the United Kingdom. <b>Lucy Kaluwi</b></p> <p>5C.3 Clusters of Long-Term Conditions and Adverse Health Outcomes in People with Multimorbidity. <b>Stefanie J. Krauth</b></p> <p>5C.4 The experiences of remote consulting for people with chronic fatigue syndrome/myalgic encephalomyelitis (CFS/ME) and fibromyalgia in primary care. <b>Helen Leach</b></p> <p>5C.5 Identifying clusters of multiple long term conditions and their associations with quality of life. <b>Lewis Steell</b></p> <p>5C.6 An academic primary care research agenda for multimorbidity: a Delphi consensus study. <b>Jonathan Stokes</b></p>	<p><b>5D Education</b> Room: CLARENCE Chairs: <i>Joe Rosenthal &amp; Marina Boulton</i></p> <p>5D.1 Communicating weight loss advice in primary care: Using conversation analysis to develop online education resources for clinicians. <b>Charlotte Albury</b></p> <p>5D.2 Can capacity limitations in primary care undergraduate placements be addressed using a blended learning approach? <b>Catherine Neden</b></p> <p>5D.3 Mapping the Impact of Early Primary Care Placements on Medical Students’ Professional Development. <b>Dr Sian-Lee Ewan</b></p> <p>5D.4 How does the General Practice curriculum understand health inequality? <b>Leonard Grant</b></p> <p>5D.5 What helps patients access online services in primary care? Free-text analysis of patient responses to the Di-Facto survey. <b>Nada Khan</b></p> <p>5D.6 General Practitioner preferences and use of evidence in clinical practice: a mixed methods study. <b>Emer O’Brien</b></p>	<p><b>5E COVID-19</b> Room: LANCASTER Chairs: <i>Emily Fletcher &amp; Umar Chaudhry</i></p> <p>5E.1 The Changing Face of Primary Care in a Pandemic: a comparison of primary care systems before and ‘after’ the Covid-19 Pandemic. <b>Susan Browne</b></p> <p>5E.2 Have the drivers of general practice appointment volumes changed as a result of the Covid-19 pandemic? <b>Tianchang Zhao</b></p> <p>5E.3 Satisfaction with remote GP consultations during the COVID-19 pandemic: a population survey of UK adults. <b>Kate Lifford</b></p> <p>5E.4 ‘You can be in hell and they still refuse to help’: Racially and ethnically minoritised patients with Long Covid highlight poor experiences of primary care. <b>Tom Kingstone</b></p> <p>5E.6 How does the impact of Covid-19 affect the work of an organisation supporting vulnerable migrants’ access to healthcare? <b>Antje Lindenmeyer</b></p>	<p><b>5F Workshop</b> Room: DURHAM BALCONY</p> <p>5F.1 Reimagining equitable primary care: Actionable insights to address inequalities in health and healthcare. <b>Anna Gkiouleka</b></p>

15:00	5A.7 Multidisciplinary medication reviews and deprescribing in primary care for older people living with frailty. <b>Dr Kinda Ibrahim</b>	5B.7 Should adults with recurrent acute tonsillitis have a tonsillectomy? <b>Frank Sullivan</b>	5C.7 How do ME/CFS patients decide what interventions to try and who to listen to? An interpretive descriptive study. <b>Meredith Vanstone</b>	5D.7 Exploring perceptions of doctors in GP specialty training with specific learning difficulties undertaking clinical and work place-based assessments for GP licensing: interview study. <b>Dr Julie Pattinson</b>	5E.7 How have pandemic-related spatial changes affected patient and staff experiences of accessing primary care? A qualitative study during the Covid-19 pandemic. <b>Lindsey Kent</b>	
15:10	5A.8 The I-WOTCH study: A randomised controlled trial of a group based intervention to support opioid tapering. <b>Harbinder Sandhu</b>	5B.8 Herpes zoster and risk of incident Parkinson's disease in US Veterans: a matched cohort study. <b>Louis Tunnicliffe</b>	5C.8 Process evaluation of a pragmatic, multicentre pilot randomised controlled trial (RCT) in primary care: Tailored Intervention for COPD and Co-morbidities by Pharmacists and Consultant Physicians (TICC PCP). <b>Karen Wood</b>	5D.8 Performance of doctors with specific learning difficulties in the UK GP licensing Applied Knowledge Test data interpretation questions. <b>Aloysius Sriwardena</b>	5E.8 Vaccine effectiveness against COVID-19-related hospital admissions and deaths in the immunocompromised population: A retrospective, population-based cohort study in England. <b>Daniel T.H. Chen</b>	
15:20	5A.9 Efficacy and safety of sacubitril/valsartan in the treatment of heart failure: A systematic review incorporating unpublished clinical study reports. <b>Dr David Byrne</b>		5C.9 Treatment burden in COPD - Findings from a pragmatic, multicentre pilot randomised controlled trial (RCT) in primary care: Tailored Intervention for COPD and Comorbidities by Pharmacists & Consultant Physicians (TICC PCP). <b>Karen Wood</b>	5D.9 Patient involvement in primary care medical education: how might their active participation be enhanced? <b>Doyin Alao</b>	5E.9 Modifying a manualised Behavioural Activation intervention for use with older adults at risk of depression and loneliness during the COVID-19 pandemic. <b>Carolyn Chew-Graham</b>	
15:30-16:00	Refreshment break					Durham
16:00	AWARD WINNERS SESSION Chairs Rupert Payne and Eduard Shantsila					Oxford
16:05-16:20	SAPC/RCGP Elective prizewinner 2022 Ioan Wardhaugh GP Workforce Recruitment and Retention in Welsh Coastal Communities - what can be done to stem the tide?					
16:20-16:30	SAPC Doctoral prizewinner presentation - Sarah Mills					
16:30-17:00	SAPC ASM 2023 Distinguished Paper presentations					
16:30-16:45	Richard Baker Do general practices in England influence life expectancy?					
16:45-17:00	Carol Bryce The hidden work of engaging with online services: ethnographic case study on digital facilitation					
17:00	SAPC ASM prize giving session					
17:10	Closing remarks ASM 2024 Bristol					
17:30	Conference closes					

# Sustainable primary care

healthy systems, healthy people



52nd SAPC Annual Scientific Meeting

**3–5 July 2024**

**University of Bristol**

Abstract submission deadline:  
**13:00, 31 January 2024**

**Welcome drinks** at the  
Royal West of England Academy  
**Wednesday 3 July**

**SAPC**  
Society for Academic Primary Care

**Gala Dinner** at  
Bristol City Museum  
**Thursday 4 July**



Email: [office@sapc.ac.uk](mailto:office@sapc.ac.uk) | web: [sapc.ac.uk](http://sapc.ac.uk) | Twitter: [@sapcacuk](https://twitter.com/sapcacuk) #sapcasm

# KEYNOTE SPEAKERS

## WEDNESDAY 19th JULY

9.30-10.45 | PLENARY 1



### Dr Becks Fisher

*Senior Policy Fellow, The Health Foundation*

Dr Becks Fisher (she/her) is currently Harkness Fellow in Health Care Policy and Practice at the University of San Francisco, California. More usually, she is an NHS GP, and Senior Policy Fellow at the Health Foundation, where she leads the organisation's work on general practice.

Becks is particularly interested in how health policy can support equitable provision of primary care services, and in models of care and payment for general practice. She has served on multiple national advisory groups, including NHS England's health inequalities in primary care advisory group, and the National Vaccine Equalities Committee for the COVID vaccine rollout.

Fisher is a cofounder of Next Generation GP, a national leadership program for early-career GPs in the U.K. She was previously a National Medical Directors clinical fellow to Sir Bruce Keogh, and an academic clinical fellow at the University of Oxford, where she held a teaching fellowship at Green Templeton College.

## THURSDAY 20th JULY

9.00-9.45 | THE 9TH HELEN LESTER MEMORIAL LECTURE



### Professor Andrea Williamson

*Professor of General Practice and Inclusion Health, University of Glasgow*

Andrea Williamson is Professor of General Practice and Inclusion Health at the University of Glasgow, a medical officer in Glasgow Alcohol and Drug Recovery Services and a GP in Glasgow Homeless Health Services, combining teaching, research and clinical practice.

Andrea has a number of roles in Glasgow Undergraduate Medical School and in post graduate medical training. She teaches and trains about the social determinants of health, Inclusion Health practice and trauma informed care. She leads on research about missingness in healthcare and is involved in wider research to improve care for people experiencing severe and multiple disadvantage.

She is a founding member of GPs at the Deep End Scotland, deputy chair of the Health Inequalities Standing Group, RCGP, is on the NIHR HS&DR research funding board, and was the primary care member of the NICE Guideline Committee 'Integrating health and social care for people experiencing homelessness'.



# COMMUNITY GROUPS

## The Clare Project

### Supporting trans, non-binary and intersex adults in Sussex

The Clare Project began in 2000 when a group of trans women started meeting in the back room of a hairdressing salon to discuss issues affecting their local community. We are now a registered charity run by and for trans, non-binary, gender-variant and gender-questioning people in Brighton, Hove and East Sussex. We run psychosocial support groups, information sessions, workshops and excursions, as well as providing information and training for individuals and organisations on community needs, and connecting people to affirmative peer support, psychotherapy and healthcare. We also offer some support and advocacy for people who are intersex/have variations in their biological sex characteristics.

After many years as a grassroots group, The Clare Project became a registered charity in 2016. We moved from supporting trans women and transfeminine people to supporting everyone whose identity falls under the transgender or non-binary umbrellas. More recently, we have also started supporting members of the intersex community.

The Clare Project now provides a variety of support options for the trans, non-binary, and intersex (TNBI) community in Brighton and across Sussex. Over the years, we have welcomed thousands of TNBI people through our doors, regardless of their gender identity, gender expression, or biological sex variation.

We pride ourselves on being TNBI-led, and TNBI-orientated in both our support services and campaigning. Over recent years, we have developed a strong Trustee Board and a small but remarkable team of workers and volunteers.

Our team, members and supporters have worked tirelessly to develop ourselves as the flagship TNBI service in Sussex. We now run social drop-ins both online and in person, monthly social meals, monthly workshops and a neurodivergent group. We have a variety of 1:1 support options. We create resources for the community, deliver training and consultancy to organisations, and are involved in running various events for the TNBI community throughout the year.

[www.clareproject.org.uk](http://www.clareproject.org.uk)

## Friends, Families and Travellers

### Working Towards Equality

We work to end racism and discrimination against Gypsy, Roma and Traveller people and to protect the right to pursue a nomadic way of life.

We support individuals and families with the issues that matter most to them, at the same time as working to transform systems and institutions to address the root causes of inequalities faced by Gypsy, Roma and Traveller people.

- We investigate and expose unfair treatment, advocate for equal rights and empower individuals to challenge inequality.
- We educate professionals to provide fair access to services.
- We celebrate Gypsy, Roma and Traveller people's rich histories, cultures and contributions to society and share this with the wider public.

We use all this to create a compelling case for change to a safer, more just society for Gypsies, Roma and Travellers.

Active since 1994, we are a leading national charity that works to end racism and discrimination against Gypsy, Roma and Traveller people and to protect the nomadic way of life.

**At least half of our Trustees, staff, interns and volunteers are from Gypsy, Roma or Traveller background.**

[www.gypsy-traveller.org](http://www.gypsy-traveller.org)

**For further information please visit these Community Groups in the Exhibition Space in the Durham.**

## POSTER DISCUSSION SESSIONS

### Format

ePoster presenters will give a 6 minute summary of their poster followed by a 4 minute Q&A in the time slots shown below. For longer discussion please follow up with the presenters after the discussion session.

Discussion will be held at ePoster stations in the Durham.

## Wednesday 19th JULY

Lunch break (12:30-14:00) discussion will begin at 13:00

### AT EPOSTER STATION A

#### CANCER Discussion leader: Nada Khan

- 13:00** 6A.1 Developing and Validating a Multivariable Lung Cancer Risk Prediction Model that identifies high-risk smokers in areas with a higher incidence of disease: ECLS and UK Biobank. **Lamorna Brown**
- 13:10** 6A.2 The effect of multimorbidity on diagnostic interval for lung cancer and mesothelioma: a cohort study using data from the Clinical Practice Research Data link. **Imogen Rogers**
- 13:20** 6A.3 'Picking up the pieces' - primary care practitioners' experiences of cancer care reviews: a qualitative study. **Dipesh Gopal**
- 13:30** 6A.4 Can community pharmacies help to reduce health inequalities in early cancer detection? **Judit Konya**
- 13:40** 6A.5 Socioeconomic Inequalities in the Diagnosis and Treatment of Ovarian Cancer in the United Kingdom: A Systematic Review and Narrative Synthesis. **Benjamin Pickwell-Smith**
- 13:50** 6A.6 Novel decision support intervention to support choice in cervical screening modality: SUCCEED or In-clinic or self-sampling for HPV: Supporting person-centred choice for cervical screening. **Eleanor Clarke**

### AT EPOSTER STATION B

#### CHILD & YOUNG PEOPLE'S HEALTH Discussion leader: Rosina Cross

- 13:00** 6B.1 Does dietary advice based on food allergy tests improve disease control in children with eczema? Trial of food allergy IgE tests for Eczema Relief (TIGER) study protocol. **Catherine Woods**
- 13:10** 6B.2 What is the relationship between socio-economic factors and self-reported health in adolescents? **Frank Sullivan**
- 13:20** 6B.3 How did an online behavioural intervention improve eczema outcomes in young people and parents/carers of children with eczema? A quantitative process evaluation. **Taeko Becque**
- 13:30** 6B.4 Young people's priorities for the self-management of distress after stoma surgery due to inflammatory bowel disease: a consensus study using online nominal group technique. **Benjamin Saunders**
- 13:40** 6B.5 A systematic review of the clinical effectiveness of dry powder inhalers in the treatment of acute exacerbations of asthma in adults and children, and in the maintenance treatment of asthma in children. **Lauren Franklin - WITHDRAWN**
- 13:50** 6B.6 Barriers to healthcare for people with a learning disability from ethnic minority backgrounds: perspectives of self-advocates and carers. **Katie Umpleby**

## AT EPOSTER STATION C

### INEQUALITIES Discussion leader: Philip Rankin

- 13:00** 6C.1 How can we improve maternal health disparities in migrant Women in the UK? **George Hedger - WITHDRAWN**
- 13:10** 6C.2 The under-representation of minority ethnic groups in academic general practice. **Alice Howe**
- 13:20** 6C.3 What barriers exist in delivering healthcare to Indigenous people living with multimorbidities in settler-colonies and how can culturally appropriate care improve outcomes: a narrative review of aetiology and management. **Harm Van Marwijk**
- 13:30** 6C.4 Barriers to healthcare faced by people with a learning disability from ethnic minority populations: unpicking the effects of COVID-19. **Christina Roberts**
- 13:40** 6C.5 Holistic health and social care outreach for people experiencing homelessness with recent non-fatal overdose: the Pharmacy Homeless Outreach Engagement Non-medical Independent prescribing Rx (PHOENIX after overdose) pilot randomised controlled trial. **Richard Lowrie**
- 13:50** 6C.6 Experiences of HIV Pre-Exposure Prophylaxis (PrEP) users in Wales during the COVID-19 pandemic – A qualitative interview study. **Zahraa Khammas**

## AT EPOSTER STATION D

### RESEARCH METHODS Discussion leader: Eduard Shantsila

- 13:10** 6D.2 The Measurement of Treatment Burden after Stroke (TRUSTED). **Frances Mair**
- 13:20** 6D.3 A SYSTEMATIC REVIEW OF THE USE OF BURDEN OF TREATMENT THEORY. **Frances Mair**
- 13:30** 6D.4 The Acceptability of Quantum-Inspired Imaging for Remote Monitoring of Health & Disease in Community Healthcare (QUEST) **Karen Wood**
- 13:40** 6D.5 Can participatory action research, focusing on reciprocal benefit, deliver more impactful research? **Claire Planner - WITHDRAWN**
- 13:50** 6D.6 The BEauty and health community LOuNGes (BELONG) study: overview and preliminary findings. **Marjorie Lima do Vale**

## AT EPOSTER STATION E

### CONSULTATIONS & WORKFORCE Discussion leader: Emily Fletcher

- 13:00** 6E.1 Do single-handed and single-partnered practices deliver high-quality personalised care? **Ian Holdroyd**
- 13:10** 6E.2 The uptake of roles through the Additional Roles Reimbursement Scheme and associations with patient experience: Analysis of General Practices and Primary Care Networks in England 2020-2022. **Chris Penfold**
- 13:20** 6E.3 Navigating the boundaries of identity when GPs work with the public outside of the consultation. A qualitative participatory action research study. **Jessica Drinkwater**
- 13:30** 6E.4 Operational failures in general practice (OFIG): A consensus-building study of the operational failures on GPs' and patients' priorities for improvement. **Ahmed Alboksmaty**
- 13:40** 6E.5 Should researchers standardise usual care arms in randomised controlled trials? **Katrina Turner**
- 13:50** 6E.6 What is the relationship between research activity and quality of care in English general practice? A mixed methods study. **Peter Bower**

## Thursday 20th JULY

Lunch break (12:45-14:00) discussion will begin at 13:00

### AT EPOSTER STATION A

#### EDUCATION *Samuel Freeman*

- 13:00** 7A.1 Performance of doctors in the UK GP licensing Applied Knowledge Test for different question lengths. **Aloysius Siriwardena**
- 13:10** 7A.2 Are we adequately preparing our GP trainees in Wessex to understand Health Inequalities and to work in areas of deprivation? **Nicola McAlister**
- 13:20** 7A.3 Bridging the Gap: The role of graduand students in developing medical education materials. **Milap Rajpara**
- 13:30** 7A.4 Using GP Fellowships to support Health Equity project implementation in Primary Care: the Newham Case Study. **Jenny Blythe**
- 13:40** 7A.5 How do the diagnostic reasoning styles of UK medical and physician associate students compare? An exploratory study using an online patient simulation tool. **Ruth Plackett**
- 13:50** 7A.6 Conceptualising undergraduate clinical general practice placements as clinical Communities of Practice: drawing on findings from a case study of an Undergraduate Longitudinal GP Placement. **Liza Kirtchuk**

### AT EPOSTER STATION B

#### LONG TERM CONDITIONS *Discussion leader: Eduard Shantsila*

- 13:00** 7B.1 WHAT DO PATIENTS WANT AND NEED IN AN EXPLANATION ABOUT OSTEOARTHRITIS? **Clare Jinks**
- 13:10** 7B.2 Can a trial of a text message intervention to improve effective use of medication rapidly recruit people with type 2 diabetes during a global pandemic? **Louise Jones**
- 13:20** 7B.3 Are alternative home- and technology supported modes of rehabilitation delivery as effective as traditional centre-based programmes for people with heart disease? Findings from a Cochrane review. **Sinead McDonagh**
- 13:30** 7B.4 Major haemorrhage in people with heart failure and atrial fibrillation: community-based cohort study. **Nicholas Jones**
- 13:40** 7B.5 Hypertension in the time of Corona -- Whose hypertension did the pandemic most affect in North East London? **Stuart Rison**
- 13:50** 7B.6 Primary care intervention development research; developing a lifestyle intervention for people living with gout. **Lorraine Watson**

### AT EPOSTER STATION C

#### PRIORITIES IN WOMEN'S HEALTH *Discussion leader: Abi Eccles*

- 13:00** 7C.1 Assessing the Acceptability and Effectiveness of Mobile-Based Physical Activity Interventions for Midlife Women During Menopause: Systematic Review of the Literature. **Ghada AlSwayied**
- 13:10** 7C.2 Oral Spironolactone for Adult Female Acne (SAFA): multicentre double-blind randomised trial. **Megan Lawrence**
- 13:20** 7C.3 Vulval lichen sclerosus in primary care: how common is it and how can we support patients? **Sophie Rees**
- 13:30** 7C.4 What are the risks of bone fractures for women when using menopausal hormonal therapy and after cessation of treatment? **Yana Vinogradova**
- 13:50** 7C.6 A Qualitative Evidence Synthesis of Women's Experiences and Attitudes of Antenatal Weighing. **Alice Maidwell-Smith**

## AT EPOSTER STATION D

### PRESCRIBING Discussion leader: Rachel Spencer

- 13:00** 7D.1 Early-career general practitioners' antibiotic prescribing for acute infections: a systematic review. **Emma Baillie**
- 13:10** 7D.2 Polypharmacy prescribing amongst ethnic groups: A scoping review. **Rima Chauhan**
- 13:20** 7D.3 How feasible is a proactive review of patients taking opioid medicines for persistent pain led by pharmacists in primary care? **Clare Jinks**
- 13:30** 7D.4 What value do pharmacist-general practitioner (GP) inter-professional collaborative discussions have in patient medication reviews? A qualitative process evaluation (IMPPP Trial). **Roxanne M. Parslow**
- 13:40** 7D.5 A cost-utility analysis of a fixed-dose combination "polypill" for primary prevention of cardiovascular events. **Ben Jacob**
- 13:50** 7D.6 How can referrals from primary care to a golf on prescription scheme be implemented? **Frank Sullivan**

## AT EPOSTER STATION E

### CONSULTATIONS & WORKFORCE Discussion leader: Victoria Tzortziou-Brown

- 13:00** 7E.1 Domestic abuse in General Practice; What are the lived experiences of medical students consulting using Forum Theatre training? **Claire McPeake**
- 13:10** 7E.2 Health care professional's role in the randomized controlled trial of the selfBACK app – a mixed-methods process evaluation. **Frances S Mair**
- 13:20** 7E.3 Can the history of primary care be used to inform its future? Developing an innovative approach to understand patient engagement with primary care services. **Barbara Caddick**
- 13:30** 7E.4 Antinuclear antibody (ANA) testing. Why did I request it and what do I do now? An observational study of UK primary care. **Will Evans**
- 13:40** 7E.5 Perspectives on access in primary care from patients, clinicians and practice staff: The PEOPLE-HULL study. **Alex Young (1)**
- 13:50** 7E.6 What are patients, caregivers, and healthcare professional's experiences of, and perspectives on, online health records access in primary care? A qualitative synthesis. **Brian McMillan**



**Primary Care in the North: Is a new approach needed?**  
SAPC: Society for Academic Primary Care North Conference

**Thursday 16 November  
2023 9.30am to 4pm**

**The conference seeks to explore good practice, innovation, and collaboration for meaningful change, through primary care research and education.**

**The conference themes are:**

- Partnering with local communities
- Improving health equity
- Embracing technological and societal change

**For more information please visit - [sites.manchester.ac.uk/sapc-north-conference](https://sites.manchester.ac.uk/sapc-north-conference)**

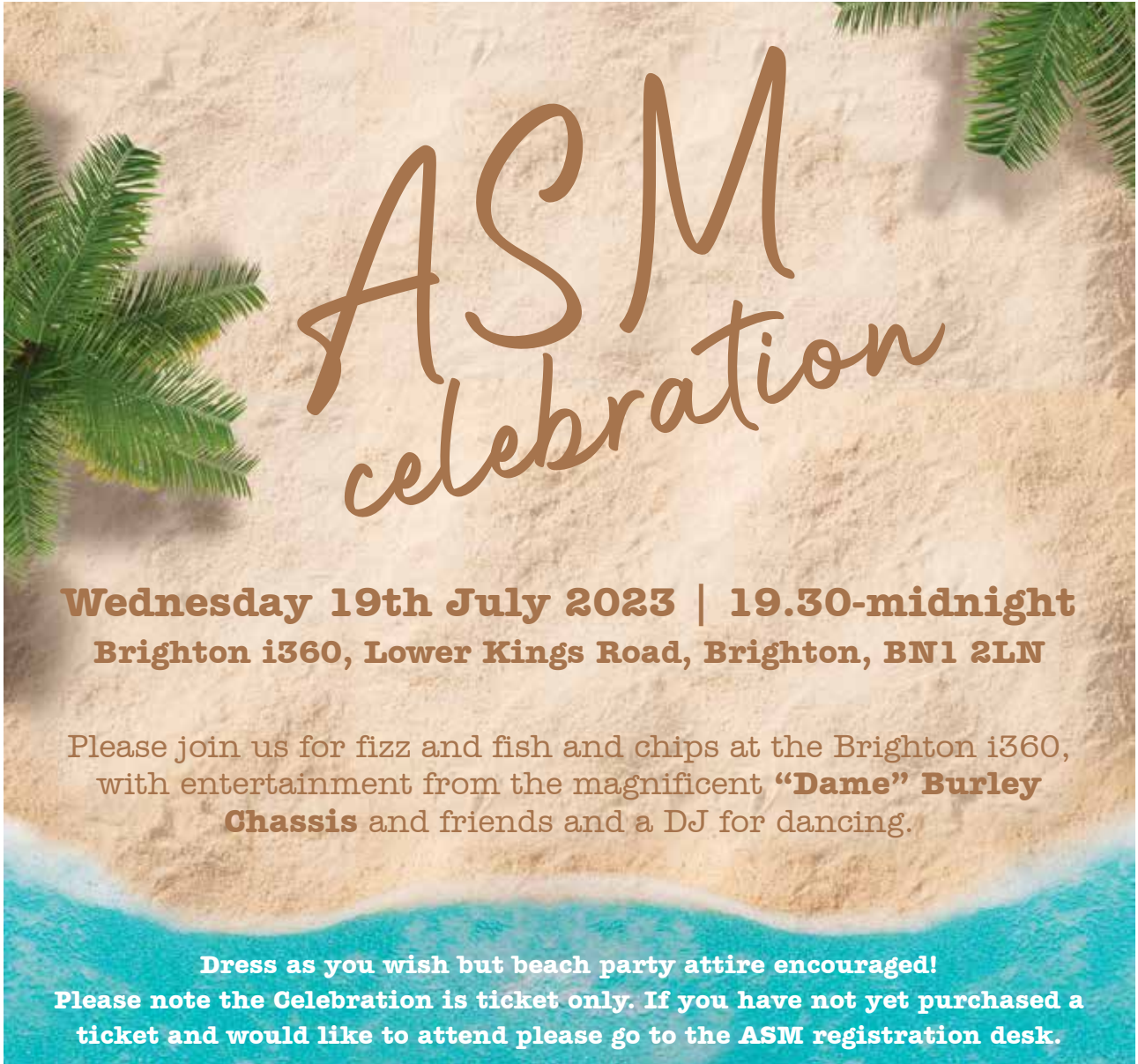

ASMC  
celebration

**Wednesday 19th July 2023 | 19.30-midnight**  
**Brighton i360, Lower Kings Road, Brighton, BN1 2LN**

Please join us for fizz and fish and chips at the Brighton i360, with entertainment from the magnificent **“Dame” Burley Chassis** and friends and a DJ for dancing.

**Dress as you wish but beach party attire encouraged!**  
**Please note the Celebration is ticket only. If you have not yet purchased a ticket and would like to attend please go to the ASM registration desk.**



**Yoga**

**Wednesday 19th July 2023**  
**17.15-18.15**  
**Doubletree Brighton Metropole, Durham**

Join **Laura Elliott** ([www.lauraselliott.co.uk](http://www.lauraselliott.co.uk)) an NHS Doctor and Yoga Teacher for some gentle yoga and wind down from the first day of the ASM.

To book please visit the registration desk in the Sussex Lounge, places are limited and booking is essential.

## WiFi

To join the Hilton WiFi please follow the steps below:

- Join "Hilton Honors" network,
- A WiFi landing page should open automatically in your browser
- Click "I have a promotional code"
- Enter access code: "VIP"
- Click "Connect"

## Pre-book workshops and optional activities

Places may be pre-booked at the registration desk for workshops throughout the conference and social events (see social events page).

## Speaker preview

Presentations should be taken to the Speaker Preview room (Office 2, opposite the Oxford) at least two hours before the start of the session in which you are presenting so that they can be transferred into the appropriate session room. If you have already submitted your presentation by email you may review and update it in Speaker Preview.

## Parallel sessions

Session chairs and speakers are requested to go to the room where the session will take place at least 10 minutes before the start time to meet each other and familiarise themselves with the audio-visual equipment. A member of the conference staff team will be present during the session to assist.

### Time slots:

Oral presentations in parallel sessions: 6 minutes presentation and 4 minutes Q&A.

## ePosters

There are scheduled times for facilitated discussion of ePosters. Please see page 18

## Press attendance - Notice to presenters and authors

There may be journalists attending the conference. If you do not wish your work to be reported please state this at the beginning of your talk. You should also let the chair of the session know.

## Publication of Abstracts

The abstracts are published on the SAPC website only, they are not available in this book.

To view the abstracts visit:

[www.sapc.ac.uk/conference/2023#schedule](http://www.sapc.ac.uk/conference/2023#schedule)

Abstracts can be viewed by clicking on the "full abstract" below each talk listed in the parallel sessions (grey shaded area).

DOI reference for abstracts and talks: 10.37361/asm.2023.1.1

DOI LINK: <https://sapc.ac.uk/doi/10.37361/asm.2023.1.1>

## Attendance certificates

If you wish to receive an attendance certificate please complete the online ASM evaluation form that will be sent out by email following the meeting.

## Car parking

Parking is available at the Hilton for those staying at the Hotel for £25 per day. For all others the nearest public car park to the venue is Regency Square, Brighton, BN1 2FG.

If you are driving from outside the city and want to avoid traffic and parking in the city centre, you can park for free at Withdean Sports Complex, BN1 5JD and purchase a bus ticket into the city.

## Quiet Room

A quiet room is available throughout the ASM in Surrey 1 for prayer, relaxation and reflection.



# MDU

The MDU is led and staffed by doctors who have real-life experience of the pressures and challenges you face every day. Their expertise in medico-legal issues, complaints and claims is unparalleled.

Since 1885, we have been indemnifying doctors for incidents arising from their clinical care of patients. We are proud of our heritage, but we are always looking forward, shaping our products and services to meet the changing needs of the medical profession.

## SAPC Ambassadors

SAPC Ambassadors are SAPC members who work with the SAPC executive and help to promote the work of SAPC within local departments and organisations. We meet roughly 3-4 times per year for one hour virtually and once in-person at the Annual Scientific Meeting. Ambassadors are researchers, educators, clinicians, primary health care scientists, or any combination at any stage in their career! We are aiming to have at least one ambassador in each department in the UK, some departments have more than one. We are happy to welcome people from further afield if you would like to be involved in promoting the work of SAPC. Being an ambassador is a great way to learn more about SAPC, influence it's work, and it is good for your CV.

**Umar Chaudhry** and **Jess Drinkwater** co-lead the ambassadors group. We are happy to be contacted ([office@sapc.ac.uk](mailto:office@sapc.ac.uk)) if you have any questions about the ambassadors or would like to become an ambassador. We will be meeting at the SAPC ASM on **Wednesday 19th July** from **3.30-4pm** at the SAPC Ambassador stall. We look forward to seeing you there.



## Primary care Academic Collaborative

### Primary Care Research for All

PACT is a collaborative research network of enthusiastic Primary Care team members who want to participate in high impact projects and learn more about research. Established in 2019, PACT now has over 600 members across the United Kingdom and is continuing to grow. PACT members include medical students, junior doctors, GP trainees, GPs, nurses, physiotherapists, physician associates, pharmacists and paramedics working in Primary Care. PACT empowers its members to gain first-hand experience in large multi-centre PACT research

projects and supports them through the data collection process. By participating in a PACT project, PACT members have the opportunity to become a published author in research journals and conference presentations. Upon completion of a PACT project GP practices are given a practice report, showing their own results benchmarked against other PACT members across the country. PACT members can compare and contrast their practices to others in the UK, and can use this data for local Quality Improvement Projects.

All primary care clinicians and researchers are welcome to join PACT via our website [www.gppact.org](http://www.gppact.org) or find out more by coming to speak to the new PACT committee at our stand.



# PEER REVIEWERS

---

## Scientific Programme Committee:

*Marina Boulton, Emily Fletcher, Samuel Freeman, Kerstin Nothnagel, Philip Rankin, Edward Shantsila, Duncan Shrewsbury*

This year 361 submissions were received including 344 presentation abstracts, 14 workshops, 3 creative enquiry pieces. All abstracts were peer reviewed by two reviewers. Reviewers scored each abstract on five areas using a five-point scale. A mean score was obtained for each abstract using the scores assigned to it by each peer reviewer. The abstracts were ranked according to mean score, and this

ranking was then used as a starting point for discussion about acceptance by the Scientific Programme Committee. The abstract scores dominated the Committee decision making but were not the sole criterion. The Committee also considered the alignment with conference themes, suitability for oral or ePoster presentation and the overall balance and fit of the programme. The final programme consists of: 5 workshops, 58 posters and 192 oral presentations including one creative piece.

**With many thanks to those listed below who reviewed the abstracts.**

Abi Moore	Jess Drinkwater	Rebecca Morris
Akke Vellinga	Jessica Weng	Rupert Payne
Alice Burnand	Jo Parsons	Ruth Jack
Alice Harper	Joanne Reeve	Ruth Plackett
Amelia Talbot	Joe Rosenthal	Samuel Freeman
Andrea Hilton	Judith Ibison	Sarah Alderson
Ann Doherty	Kate Dunn	Sarah Milosevic
Ann Kiely	Kevin McConville	Sarah Tonkin-Crine
Carol Coupland	Kimberley Foley	Shoba Dawson
Carolyn Chew-Graham	Leanne Shearsmith	Stefanie Disbeschl
Claire Jinks	Lindsey Kent	Sue Cooper
David Humphreys	Louise Hall	Tasneem Khan
Deborah McCahon	Marina Boulton	Tom Witney
Eduard Shantsila	Matthew Ridd	Umar Chaudhry
Emily Fletcher	Narin Aker	Victoria Ford
Emma Healey	Natalia Lewis	Victoria Silverwood
Fiona Wood	Nicola Copper-Moss	Vishal Aggarwal
Ghada AlSwayied	Peter Bower	Vivian Ramsden
Heather Barry	Rachel Johnson	Will Coppola
Helen Parretti	Rachel Spencer	

**If you would like to assist with reviewing abstracts for the ASM in future please email [office@sapc.ac.uk](mailto:office@sapc.ac.uk)**





# DOUBLETREE BY HILTON BRIGHTON METROPOLE

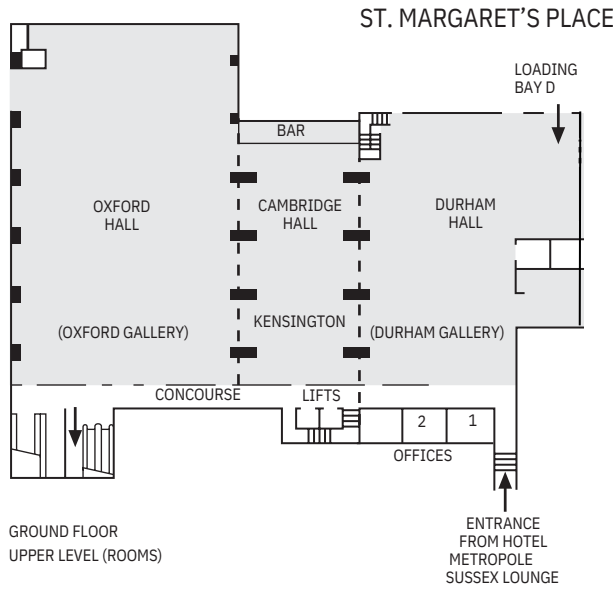

CANNON PLACE

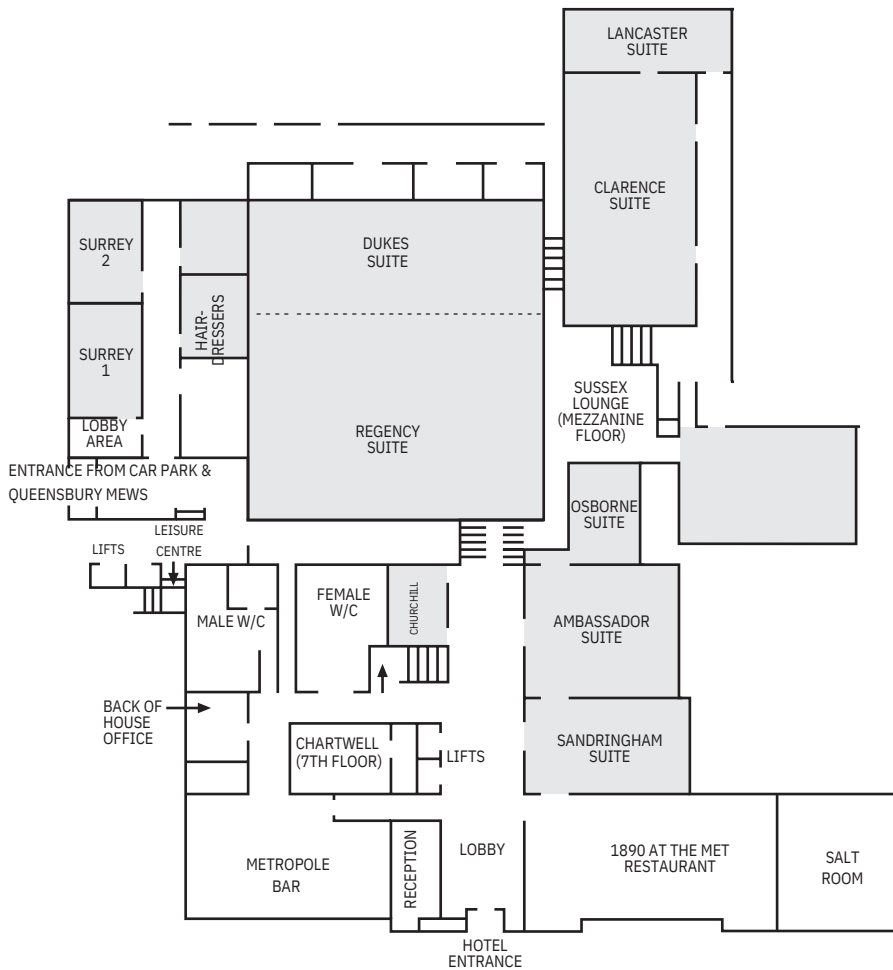

CANNON PLACE

CONFERRING ROOMS  
GROUND FLOOR

106 - 121 | KING'S ROAD | BRIGHTON | BN1 2FU