

LEADING THE FUTURE OF PRIMARY CARE

24th-26th
JUNE
2026

UNIVERSITY OF
ST ANDREWS

EMAIL - OFFICE@SAPC.AC.UK
WEB - SAPC.AC.UK
@SAPC.AC.UK #SAPC2026 #SAPC_ASM

PROGRAMME

 University of
St Andrews

SAPC
Society for Academic Primary Care

54TH SAPC ANNUAL SCIENTIFIC MEETING

Photo credit: The University of St Andrews

CONFERENCE COMMITTEE

Chair:
FRANK SULLIVAN

Scientific Programme Lead:
SARAH MILLS

ORGANISERS

KATIE TRACE & JULIET BALDWIN, SAPC

EVENT DESIGNER

MARK ORRISS (www.orriss-design.co.uk)



From left to right: Samuel Warne, Chinelo Egwu, Frank Sullivan, Zoe McElinney, Angela Flynn, Sarah Mills, Panna Muqit, Rebecca Walmsley, Karen Nicolson, Jan Low

ELECTRONIC PROGRAMME AND ABSTRACTS

Abstracts can be found on the online programme
<https://virtual.oxfordabstracts.com/#/e/sapc-asm2026-st-andrews/program>

Create your own personal programme of talks within parallel sessions by logging into Oxford Abstracts and bookmarking sessions/presentations.



NETWORKING

As in previous years, we are offering different ways to meet new people at the conference. This can be especially helpful if you are an early career researcher, are new to SAPC, a public participant, or if you are not attending with your own colleagues.

• **A newcomers' welcome space** at Forbes Bar, Agnes Blackadder on Wednesday from 12:15-12:50pm. This will be hosted by our friendly colleagues from St Andrews. Come and join them; bring your lunch!

• **PHoCuS lunch meeting** on Wednesday from 12:00-12:50pm. PHoCuS is a section of SAPC which represents Primary Health Care Scientists. The group addresses career development needs of our members who don't come from a medically qualified background. Lunch will be provided.

• **The conference run and walk** will take place on Friday 26th June at 7am - meet outside the Gateway Building. This is a great opportunity to meet other delegates.

• **PPI reception** for patient and public contributors will be held during the Thursday morning refreshment break in the Medical Building café. Come and meet other public contributors and SAPC colleagues supporting PPI.

• **SAPC Ambassadors' meeting** will be held during the refreshment break on Thursday afternoon. Come along to meet fellow Ambassadors, or perhaps come and chat if you are interested in representing your department as a SAPC Ambassador to find out more about what they do.

A VERY WARM WELCOME TO THE 54TH SAPC ASM, 2026

Welcome to the Society for Academic Primary Care (SAPC) 2026 Annual Scientific Meeting!

Dear Colleagues and Friends,

On behalf of the organising committee, I want to welcome you to this year's SAPC in St Andrews: the first time we have hosted this event. The SAPC conference is the most prestigious academic primary care event of the year bringing together all of you: researchers and educators from diverse backgrounds and workplaces. In addition to its main academic purpose, the conference provides career enhancing opportunities to interact with future colleagues.

This year's theme, "*Leading the Future of Primary Care*", emphasises the importance of your role at a challenging time. The SAPC conference provides a platform for exchanging ideas, fostering collaborations, and showcasing the latest research that should inform clinical, educational and policy decisions in the UK in coming years.

We have an exciting lineup of plenary speakers who will share their insights with us in relation to the conference themes. The 12th Helen Lester Memorial will be given by Prof Richard Byng on How primary care can respond to the 'mental health crisis' at the end of the second day. On

the evening of the second day delegates attending the dinner will have a bagpiper to welcome them at the Old Course Hotel.

In addition to the academic program, we are delighted to offer an exciting social program designed to foster connections and celebrate our community. Our social program features opportunities to explore the best of what St Andrews has to offer, including short guided tours of the ancient town, a dawn walk/jog/run on the magnificent West Sands Beach (from that Chariots of Fire scene), alongside a beachside sauna experience, and even some potential opportunities to enjoy the hallowed links turf at the Home of Golf.

Whether you are an experienced researcher, neophyte, educator, or practitioner, we believe there is something here for everyone. We encourage you to take full advantage of the networking opportunities, share your insights, and be inspired by the collective knowledge and passion of our community.

Thank you for joining us, and we look forward to a productive and inspiring conference.

Frank Sullivan

Conference chair
On behalf of the 2026 conference organising committee

CONTENTS

PROGRAMME	7
KEYNOTE SPEAKERS	22
POSTERS	26
SOCIAL PROGRAMME	27
CONFERENCE INFORMATION	28
PEER REVIEWERS	29
CONFERENCE EXHIBITOR	29
ST ANDREWS FLOOR/SITE PLANS	34
LOCAL MAP	BACK PAGE

PROGRAMME AT A GLANCE

DAY 1: WEDNESDAY 24TH JUNE

08:45	Registration opens	Medical Building foyer
09:00-13:00	Education Research SIG meeting	Gateway Lecture Room 4
09:10-11:00	Mackenzie Group meeting	Gateway Boardroom
10:00-11:00	SIG meetings session 1	See programme pages
11:00-12:00	SIG meetings session 2	See programme pages
11:00-12:50	HoDs meeting	Gateway Boardroom
12:00-12:50	PHoCuS Group meeting	Gateway Lecture Room 3
12:00-13:00	Lunch break	Agnes Blackadder Hall
12:15-12:50	Newcomers welcome space	Agnes Blackadder, Forbes Bar
13:00-13:50	Conference opening Prof Frank Sullivan and Prof Deborah Williamson Opening Plenary Dr Victoria Tzortziou Brown, Prof Stewart Mercer, Dr Charlotte Mason-Apps The future workforce	Red room, Medical Building
14:00-15:00	Parallel session 1 Diagnostics, Screening & Early Detection; Cardiovascular & Metabolic Health; Prevention, Lifestyle, Social Prescribing & Community; Women's, Maternal & Reproductive Health; Respiratory & Infectious Disease Workshop 1A Krysia Canvin <i>Widening inclusion of underserved groups: using creative approaches to achieve epistemic justice</i> Workshop 1B Dariush Saeedi <i>Innovative Placements for the Future of Primary Care: Lessons from a Multi-Site Pilot</i>	See programme pages
15:00-15:30	Refreshment break	Medical Building café
15:30-16:05	Parallel session 2 Mental Health & Neurodiversity; Cardiovascular & Metabolic Health; Diagnostics, Screening & Early Detection; Medicines, Prescribing Quality; Respiratory & Infectious Disease	See programme pages
16:15-17:20	Parallel session 3 Cardiovascular & Metabolic Health; Diagnostics, Screening & Early Detection; Mental Health & Neurodiversity; Respiratory & Infectious Disease; Service Models Workshop 3A Lotte Elton <i>Choosing wisely, doing better: reducing low-value care in General Practice</i> Workshop 3B Angela Flynn <i>Reimagining Primary Care: Developing Change Agency and Leadership Skills for Future Practice</i>	See programme pages
17:30-18:30	Conference drinks reception	Medical Building café

PROGRAMME AT A GLANCE

DAY 2: THURSDAY 25TH JUNE

08:00	Registration opens	Medical Building foyer
08:30-09:20	Welcome to day 2 Plenary 2 Prof Joanne Protheroe, Prof Lindsey Pope, Prof Val Wass The future of medical education in primary care	Red
09:20-09:50	Distinguished papers from the annual meeting of Australasia & America Claire Jackson <i>Implementation of the Virtual Integrated Practice (VIP) Partnership Program: Supporting access to primary care in rural Queensland</i> Rebecca Rossom <i>Randomized Trial of a Clinical Decision Support System for Primary Care of Opioid Use Disorder</i>	Red
09:50-10:20	Presentations of Distinction Lucy Pocock <i>Findings from the SHIPS study (SHaring Information at the Primary/Secondary care interface): an ethnography across two hospital trusts in England</i> Saravana Pandian Boominathan <i>Rapid Recruitment into a Primary Care Digital Therapeutic Trial Using a Direct-to-Patient Strategy: The RiSolve Study in Ireland</i>	Red
10:20-10:50	Refreshment break	Medical Building café
10:50-12:05	PPI Reception Parallel session 4 Access, Equity & Inclusion; Digital Health, AI & Data Driven Primary Care; Multimorbidity & Complex Care; Medicines Optimisation, Safety & Stewardship; Workforce, Roles & Service Models Workshop 4A Emmanuel Uduh & Rebecca Denniff <i>Bridging communities and primary care staff to improve research involvement: what works, what gets in the way, and what can shape future practice</i> Workshop 4B Clare Goyder <i>Co-design workshop: Shaping the future of heart failure diagnosis in primary care using a participatory approach</i>	See programme pages
12:05-13:15	Lunch break	Agnes Blackadder Hall
12:30-13:10	SAPC Updates, followed by SAPC Annual General Meeting	Red
13:15-14:30	Parallel session 5 Continuity, Care Coordination & Primary-Secondary Interface; Access, Equity & Inclusion; Digital Health, AI & Data-Driven Primary Care; Multimorbidity & Complex Care; Medicines Optimisation, Safety & Stewardship Workshop 5A Frances Mair <i>From Evidence to Impact: How Primary Care Can Lead the Fight Against Cardiovascular Inequalities</i> Workshop 5B Rebecca Morris/PRIMER <i>Beyond tokenism: meaningful lessons from peer-research on the future of general practice</i>	See programme pages
14:30-15:00	Refreshment break	Medical Building café
15:00-16:20	SAPC Ambassadors' Reception Parallel session 6 Workforce, Roles & Service Models; Continuity, Care Coordination & Primary-Secondary Interface; Access, Equity & Inclusion; Digital Health, AI & Data-Driven Primary Care; Multimorbidity & Complex Care Workshop 6A Caroline Nicholson <i>Leading, influencing and collaborating for health: insights from Australia, Canada and Scotland</i> Workshop 6B Leila Saeed <i>Designing Team-Based Learning (TBL) to prepare medical students for the ethical challenges of General Practice</i>	See programme pages
16:30-17:15	12th Helen Lester Memorial Lecture Prof Richard Byng <i>How can primary care respond to the 'mental health crisis'?</i>	Red
18:30-01:00	Conference dinner and dance (Pre-booked tickets only)	Old Course Hotel

PROGRAMME AT A GLANCE

Day 3: Friday 26th June

08:00	Registration opens	Medical Building foyer
08:30-09:15	Welcome to Day 3 Award Winners Session SAPC Doctoral prize - Emilie Couchman Title: <i>Rethinking Continuity: A Doctoral Journey Through a Mesothelioma Lens</i> OECR Academic General Practitioner - Veline L'Esperance Title: <i>From GP Funding to Genomics: A Journey Through Health Inequality</i> OECR Primary Care Scientist - Francesca Dakin Title: <i>Digital presences and futures: impacts of the ongoing digitalisation of UK general practice on patients and staff</i>	Red
09:15-10:00	Dangerous Ideas Soap Box	Red
10:00-10:30	Refreshment break	Medical Building café
10:30-11:35	Parallel session 7 Workforce, Roles & Service Models; Continuity, Care Coordination & Primary-Secondary Interface; Access, Equity & Inclusion; Diagnostics, Screening & Early Detection; Digital Health, AI & Remote Care Workshop 7A Karen Wood <i>Can you break into General Practice? Using escape rooms in research, teaching and engagement</i> Workshop 7B Farhana Badshah <i>Embedding Generalism in Undergraduate Medical Education: Principles to Practice</i>	See programme pages
11:40-12:10	Parallel session 8 Workforce, Roles & Service Models; Mental Health & Neurodiversity; Safety & Quality; Patient Perceptions and Public Involvement; Pedagogy	Red
12:20-13:05	Plenary 4 Dr Munro Stewart Sustainable healthcare	Red
13:05-13:30	Prize Giving and ASM 2027 Preview	Medical Building café
13:30	Conference close & take-away lunch	



Day 1: Wednesday 24th June

TIME	LOCATION
08:45	Medical Building foyer
09:00 - 13:00	Purple (Gateway Lecture room 4)
09:10 - 11:00	Gateway Boardroom
10:00 - 11:00	Gateway - Seminar room 1
	Gateway - Seminar room 2
	Gateway - Seminar room 3
	Agnes Blackadder Hall Function Room
11:00 - 12:00	Gateway - Seminar room 1
	Gateway - Seminar room 2
	Gateway - Seminar room 3
	Agnes Blackadder Hall function Room
	Gateway - Meeting room 1
	Gateway - Meeting room 2
11:00 - 12:50	Gateway Boardroom
12:00 - 12:50	Gateway Lecture room 3
12:00 - 13:00	Agnes Blackadder Hall
12:15 - 12:50	Agnes Blackadder, Forbes Bar
13:00 - 13:10	Red room, Medical Sciences Building
13:10 - 13:50	Red room, Medical Sciences Building
08:45	Registration opens
09:00 - 13:00	Education Research SIG meeting
09:10 - 11:00	Mackenzie Group meeting
10:00 - 11:00	SIG meetings session 1
	o Digital Tech in PC
	o Sexual and Reproductive Health Research
	o Primary care Academic Collaborative (PACT)
	o Mental Health
11:00 - 12:00	SIG meetings session 2
	o Urgent Primary and Community Care
	o Multiple long term conditions
	o Continuity of Care
	o Inclusion health/Deep End research
	o Behaviour Change
	o Palliative Care
11:00 - 12:50	HoDs meeting
12:00 - 12:50	PHoCuS Group meeting
12:00 - 13:00	Lunch break
12:15 - 12:50	Newcomers welcome space
13:00 - 13:10	Conference opening: Prof Frank Sullivan, Prof. 1y Care Medicine and Prof Deborah Williamson, Dean of Medicine
13:10 - 13:50	Opening plenary Speakers: Dr Victoria Tzortziou Brown, Prof Stewart Mercer, Dr Charlotte Mason-Apps Title: The future workforce Chair: Prof Frank Sullivan

Parallel session 1						
14:00 - 15:00	Red - (Medical Building) Diagnostics, Screening & Early Detection	Orange - (Medical Building) Cardiovascular & Metabolic Health	Yellow - (Medical Building) Prevention, Lifestyle, Social Prescribing & Community	Green - (Medical Building) Women's, Maternal & Reproductive Health	Blue - (Gateway) Respiratory & Infectious Disease	Pink - (Gateway) WORKSHOP 1A
14:00	163 Jessica Watson Accessible Results: A Qualitative Study of Diverse Patients' Experiences of Online Blood Test Communication	165 Sinead McDonagh Co-producing patient-led lifestyle and self-care guidance for atrial fibrillation: a person-based, evidence-informed approach using patient and public involvement	189 Celine Esuruoso Community insights on health care: themes from community-engaged student projects during undergraduate GP placements	52 Laura-Jane McCarthy General Practitioners and women's experience of perimenopausal consultations: a qualitative evidence synthesis and meta-ethnography	134 Yangzihan Wang A randomised controlled trial assessing effectiveness and cost-effectiveness of a primary care intervention to promote engagement in an online health community for adults with troublesome asthma: work in progress	279 Krysia Canvin Widening inclusion of underserved groups: using creative approaches to achieve epistemic justice
14:15	87 Alfariyani Fatimah Access, Workforce, and Equity: Practice-level predictors of cancer diagnostic activity in English general practice	69 Juan Carlos Bazo-Alvarez Early HbA1c and weight changes after antipsychotic initiation in severe mental illness: an interrupted time-series study using primary care electronic health records	182 Elizabeth Thomas A systematic search and thematic synthesis of barriers and facilitators to accessing and engaging in green prescriptions for inclusion health groups	66 Sharinne Crawford A co-design approach to inform the development of an Endometriosis Management Plan in Australian primary care	36 Nicholas Zwar Activating Primary Care COPD Patients with Multimorbidity (APCOM) Trial - early findings	331 Dariush Saeedi Innovative Placements for the Future of Primary Care: Lessons from a Multi-Site Pilot
14:30	192 Patrick Moynagh Methods and criteria used to evaluate public-facing written information on medicines: a scoping review	268 Christiana Smith Pre-hospital Barriers to Timely Stroke Care in the UK: A Systematic Review Examining Ethnic Inequalities (2002-2026)	238 Kieran Sweeney Interventions for multimorbidity involving depression or anxiety: A systematic review with meta-analysis	203 Dr Enav Zusman Engaging health system, service, and government for expanded scope of practice: Could pharmacists insert contraceptive implants?	274 Andreas Bernd Hans Klug Efficacy and Safety of Prednisolone and B-Vitamins in Post-COVID-19 Syndrome: Results from a Randomized, Double-Blind, Placebo-Controlled Trial	
14:45	306 Gary Abel Feasibility testing of a communication tool intervention aimed at improving cancer diagnosis pathways in general practice for patients with anxiety and/or depression	125 Sinead McDonagh A Systematic Review Of Blood Pressure Monitor Validation Studies	266 Alex Young The acceptability of an at-home urine test for HPV screening for those aged 60-79: The Catch-Up Screen Study	313 Frank Sullivan Effect of a comprehensive antibiotic stewardship programme on antibiotic prescribing for acute respiratory infections in rural primary care facilities in China		
15:00 - 15:30	Refreshment break					Medical Building café

Parallel session 2						
15:30 - 16:05	Red - (Medical Building) Mental Health & Neurodiversity	Orange - (Medical Building) Cardiovascular & Metabolic Health	Yellow - (Medical Building) Diagnostics, Screening & Early Detection	Green - (Medical Building) Medicines, Prescribing Quality	Blue - (Gateway) Respiratory & Infectious Disease	
15:30	12 Carolyn Chew-Graham Challenges of discharge from Early Intervention in Psychosis Services to primary care: a multi-perspective qualitative study	90 Babu Karavadra A systematic review of commencing full dose antihypertensives in newly diagnosed hypertension	82 Andrew Palmer Feasibility testing the inter-cultural acceptability of a shared decision-making intervention	48 Matthew Booker Developing a novel point-of-care test to tackle antimicrobial resistance in Urinary Tract Infections: insights from a co-design approach for translational product development in primary care settings (the SCFI Project)	98 Katie Saunders PHARM-LC: Developing and evaluating a Long Covid Training resource for Community Pharmacy Staff. A Multi method study	
15:35	320 Kelly Birtwell A realist review of the evidence on general practice support for autistic adults	168 Sinead McDonagh Patient-led interventions to manage symptoms and episodes of atrial fibrillation (PALP-AF): an umbrella review	122 Hillary Collins Perceptions and experiences of involving Patient Research Partners in HIPPOCRATES, a pan European research consortium focussed on improving diagnosis and treatment of Psoriatic Arthritis	115 Anna Pathmanathan Health inequalities in antimicrobial stewardship: associations between ethnicity and antibiotic prescribing for respiratory tract infections	118 Clare Clement Evaluating and Optimising C-Reactive Protein (CRP) Point of Care Testing for Lower Respiratory Tract Infections (LTRIs) in Wales: The SPARROW study	
15:40	311 Kelly Birtwell I'm in the mood for dancing: supporting engagement in physical activity for autistic adults through dance	89 James Faulkner The effects of uninterrupted and interrupted sitting on blood pressure and arterial stiffness in patients with stroke	132 Caroline Nicholson Risk of frailty screening and management of older people in general practice in a region experiencing workforce shortage	71 Juan Carlos Bazo-Alvarez How comparable are antipsychotic dose-equivalence methods? A review and agreement map for primary care research	8 Alice Halim Pooled rates and demographics of POTS following SARS-CoV-2 infection versus COVID-19 vaccination: Systematic review and meta-analysis	
15:45	252 Tamsin Fisher 'I'm not old' and 'you can't use the word depression': Navigating stigma in the co-design of a mental health intervention for people over the age of 60	260 Lakshmi Chandrasekaran Perceptions of People Living with Diabetes and Healthcare Professionals Towards AI-Assisted Screening in the Diabetic Eye Screening Programme: A Mixed-Methods Study	308 Kath Williamson A United Kingdom (UK)-wide survey of health and care professionals exploring specialist weight management services for housebound people with obesity: The Housebound Obesity Pathways and Engagement (HOPE) study	155 Amelia Taylor Systematic review examining the benefits of professional, organisational and structural interventions to reduce preventable medications adverse events in primary care	133 Vicky Mengqi Qin Evaluating PUMA as an Opportunistic COPD Case-Finding Tool in Singapore Primary Care	
15:50	301 Anna Zatorska Healthcare Access, Mental Health Needs, and Research Priorities for People Seeking Refuge: A Knowledge Exchange Event in St Helens, UK	195 Asma Chabounu Is a 1-Year All-Cause Mortality Risk Model Feasible for Older Adults Using Primary Care Data?	126 Sarah Mills Equity-sensitive implementation of prognostic screening for palliative care among patients and caregivers with protected characteristics	108 Marie Ann Mae En Wong Teamlet functioning in public primary care clinics in a regional health system in Singapore: analysis of routine quality monitoring data	272 Lydia Iladiva Experiences of Implementing the Structured Chronic Disease Management Programme for COPD in Irish General Practice: A Qualitative Study	
15:55	172 - Vicky Taxiarchi Changes in care patterns and adverse outcomes among CYP with common mental health disorders in primary care	281 - Kritika Mishra Exploring lived experiences of ethnic minority patients and healthcare professionals in the familial hypercholesterolaemia (FH) care pathway in the UK	332 Tomson Lui Unboxing health testing: a thematic analysis of public perceptions of commercial health tests	46 Carolyn Chew-Graham Improving Primary Care Services for Imprisoned Women with Severe Mental Illness (IP-SIS)		

DAY 2: THURSDAY 25TH JUNE

08:00	Registration opens	Red
08:30 - 08:35	Welcome to day 2 Dr Sarah Mills	
08:35 - 09:20	Plenary 2 Speakers: Prof Joanne Protheroe, Prof Lindsey Pope, Prof Val Wass Title: The future of medical education in primary care Chair: Dr Zoe McElhinney	
09:20 - 09:50	Distinguished papers from the annual meeting of Australasia & America Speaker: Claire Jackson Title: <i>Implementation of the Virtual Integrated Practice (VIP) Partnership Program: Supporting access to primary care in rural Queensland</i> Speaker: Rebecca Rossom Title: <i>Randomized Trial of a Clinical Decision Support System for Primary Care of Opioid Use Disorder</i> Chair: Dr Rebecca Walmsley	
09:50 - 10:20	Presentations of distinction Speaker: Lucy Pocock Title: <i>Findings from the SHIPS study (Sharing Information at the Primary/Secondary care interface): an ethnography across two hospital trusts in England</i> Speaker: Saravana Pandian Boomnathan Title: <i>Rapid Recruitment into a Primary Care Digital Therapeutic Trial Using a Direct-to-Patient Strategy: The RiSolve Study in Ireland</i> Chair: Dr Karen Nicholson	
10:20-10:50	Refreshment break PPI reception	Medical Building café
10:50-12:05	Parallel session 4	
	Red - (Medical Building) Access, Equity & Inclusion	Pink - (Gateway) WORKSHOP 4A
10:50	185 Kelly Howells Integrating primary care for people experiencing homelessness: A qualitative study across four integrated care systems	143 Emmanuel Uduh & Rebecca Denniff Bridging communities and primary care staff to improve research involvement: what works, what gets in the way, and what can shape future practice
	Orange - (Medical Building) Digital Health, AI & Data Driven Primary Care	Blue - (Gateway) Workforce, Roles & Service Models
	159 Christopher Burton Can we identify low-value disease monitoring? Implementation of a rational approach to monitoring in a routine primary care database	42 Francesca Dakin Teamwork and relational infrastructure in modern UK general practice
	Yellow - (Medical Building) Multimorbidity & Complex Care	Green - (Medical Building) Medicines Optimisation, Safety & Stewardship
	146 Irene Bossman Ethnic inequalities in multiple long term conditions: a global systematic review	323 Frances Mair Antipsychotic Medications in Primary Care (AMP) Study
	Blue - (Gateway) Workforce, Roles & Service Models	Purple - (Gateway) WORKSHOP 4B
	5 Bhautesh Jani Depression and Anxiety as predictors of Multimorbidity Development: Comparison between the UK and Denmark	175 Clare Goyder Co-design workshop: Shaping the future of heart failure diagnosis in primary care using a participatory approach

11:05	298 Anna Zatorska A Qualitative Exploration of the Lived Experience of Digital Access to and Remote Consultation in General Practice among People with Multiple Long-term Conditions and who are d/Deaf	75 Nóirín Fitzgerald Guiding the Next Generation: GP Educators' Views on GP Career Choices in Ireland	
11:20	70 Euan Warner Winter pressures in UK primary care: an evidence synthesis of the impacts on general practice and patient inequalities	138 Louis Levene The transformation of England's NHS general practitioner workforce and decreasing full-time equivalent (FTE) intensity: a longitudinal analysis, 2015-2025	
11:35	170 Vicky Taxiarchi Identifying and describing people experiencing homelessness in England	225 Rosie Harrison How is Advice and Guidance perceived by patients, clinicians and healthcare commissioners: qualitative findings from the BADGER study	
11:40	95 Patrick Burch Primary care enhanced access hubs: Policy Intent and Real-world Use: Patient Experiences through the Lens of Continuity, Candidacy and Recursivity	222 Rosie Harrison Primary Care Clinician decision-making around Advice and Guidance: Qualitative findings from 'Building an evidence base for the use of Advice and Guidance Referrals at the primary-secondary care interface' (BADGER) study	
	57 Callum Leese Uptake and equity of the parkrun practice initiative in English general practice: a cross sectional study	15 Alissia Hui The efficacy of long-acting reversible contraception as treatment for endometriosis: a systematic review and meta-analysis	
	27 Katharine Wallis Redressing long term antidepressant use (RELEASE) in general practice	205 Takayuki Ando Long-term conditions and Multimorbidity development trajectories in the population across different age groups in Japan, the UK and Denmark	
	199 Marianne McCallum "Developing Equity-focused Interventions for Socio-economically deprived communities Through Participatory Co-design" (DEMIST-PC)	177 Juan Carlos Bazo-Alvarez HbA1c changes after statin initiation among people prescribed antipsychotics: interrupted time-series evidence from English primary care electronic health records	
	284 Anna Evans Digital Disconnection: Who needs help to stay connected with primary care?	131 Peter Hanlon Prescribing cascades in people with type 2 diabetes: Analyses of two representative routine healthcare databases	
	72 Janaki Chaountharagnanan Are Older Adults with Chronic Kidney Disease Receiving the Correct Gabapentinoid Dose Based on Creatinine Clearance?	241 Brian McMillan CHARIOT - A Cardiovascular Health Assessment and Risk-based Intervention Optimisation Tool: A digital adjunct to the NHS Health Check	
	105 Mishal Fatima Relative effectiveness of digital health interventions: umbrella review	40 Eleanor Hoverd Understanding the contextual and causal factors shaping the work of receptionists in general practice: a realist review	
	282 Sandra Dyer Integrated primary palliative care for adults with advanced multimorbidity and palliative care needs: What works, for whom, how and in which contexts? A Realist Synthesis		

11:50	226 Hannah Mahoney The Accessing Continuity study: Development and recruitment using the Primary care Academic Collaborative (PACT)	24 Rosie Essery Optimising the Acne Care Online intervention: community engagement with young people with ethnically diverse skin tones	152 Polly Duncan Why we can and should include underserved communities in research: insights from an interview study of older house-bound patients	295 Hannah Scobie Managing conflicts-of-interest at an organisational level: A preliminary framework for healthcare organisation refusal of industry funding	251 Jade Hooper Pathways into Rural and Deep-end General Practice: A Retrospective Cohort Study from Scotland
11:55	216 Molly Dineen Interventions to improve continuity of care in primary health care: a scoping review in the USA and Canada	221 Joseph Lee REDUCE-HF, an electronic health records study in OpenSAFELY: Understanding the relationship between health service utilisation and heart failure diagnosis	297 Samuel Warne Evaluating the impact of the NHS Grampian Step Count Challenge on employee fitness and wellbeing during two challenge periods: a repeated-measures analysis	112 Emma Murphy General Practitioner supervision of First Contact Practitioners in Kent, Surrey and Sussex: a qualitative study exploring factors considered important in the provision of effective supervision	
12:00	280 Jonathan Fitzsimon The Potential of a Hybrid Approach to Primary Care in Hard To Serve Communities	329 Angus Perry Closing the loop: designing an AI-enabled system linking PROMs, patient activation and accountability for personalised prevention in primary care	236 Yuan Tian Low-Value Care in English Primary Care: Quantifying Prevalence, Practice Variation, and Associated Patient and Practice Factors	140 Benjamin Atta Owusu Explainable Machine Learning Models for Predicting Falls in the Primary Care Heart Failure (HF) Population: a database cohort study	206 Chris Dickie What Factors Drive Vocational (Foundation Years) Doctors to Choose General Practice? An Australian National Mixed Methods Study
12:05 - 13:15	Lunch break				
12:30 - 13:10	SAPC Updates, followed by SAPC Annual General Meeting				
13:15 - 14:30	Parallel session 5				
13:15	Red - (Medical Building) Continuity, Care Coordination & Primary-Secondary Interface	Orange - (Medical Building) Access, Equity & Inclusion	Yellow - (Medical Building) Digital Health, AI & Data-Driven Primary Care	Green - (Medical Building) Multimorbidity & Complex Care	Blue - (Gateway) Medicines Optimisation, Safety & Stewardship
	305 Sara Eddy 'Let's reconnect for a better future': A Realist Evaluation of Continuity of Care in General Practice: Introducing the ReCONNECT Study	321 Douglas Andrew The impact of co creation in undergraduate health equity focused clinical placements: insights from medical students	16 Christina Derksen Who's Using AI Scribes in UK Primary Care? A Survey of General Practitioners	58 Ailish Byrne Healthcare Utilisation and its Variation in People with Fibromyalgia: A Systematic Review and Meta Analysis	129 Rosanna Fennessy Expanding roles and hidden work: A qualitative study of how community nurses navigate and adapt injectable medication care to provide timely end of life symptom control
13:30	14 Isobel Joy McFadzean Incidence and nature of avoidable healthcare associated harm in prisons: a retrospective case note review study of 18 prisons in England	183 Harini Sathanapally "They think you are making it up": health care experiences in the context of breathlessness in culturally diverse communities	4 Anna Price Co-developing an evidence-based AI Virtual Assistant for young people living with ADHD, optimised for prescription via primary care: Recommendations from Experts by Lived Experience and healthcare professionals	289 Sara McKelvie A Realist Review of Community Alternatives to Acute Hospitalisation for Older People who have Fallen (CATCH falls)	283 Tomazo Kallis Sources of clinical uncertainty and observed linguistic practices in primary care polypharmacy medication reviews
13:45	262 Serge Engamba Relational continuity of care in addiction and dual diagnosis: a systematic review protocol	109 Nicola Ditzel Reasonable Adjustments in Learning Disability Annual Health Checks: A Co designed Qualitative Study	239 Stephanie Stockwell Mixed methods evaluation of the NHS Health Check Online pilot programme across 11 local authorities in England	291 Steven Gilmore Examining the prevalence of Fall Risk Increasing Drugs in older community dwelling people and its association with hospital admissions and prescription modification	209 Matthew Ridd Does prophylactic low dose amitriptyline prevent post-herpetic neuralgia? Findings from the AMITRIPTYLINE for the prevention of post-HERPETIC NEURALGIA (ATHENA) multicentre, individually randomised, pragmatic, placebo-controlled superiority trial
14:00	275 Mary Carter Continuity of care in team based general practice: A qualitative study of practice based pharmacists in England	130 Emma Copland Disparities in avoidable mortality in adults with and without learning disabilities in England between 2000 and 2024	43 Francesca Dakin AI enabled access and triage in UK general practice: results of a qualitative scoping study	326 Bhautesh Jani The built environment and multimorbidity: a systematic review	211 Greg Logan Scottish Sore Throat Test and Treat (S2T3) Feasibility Pilot
14:05	230 Brian McMillan Accessible Results: A qualitative study with primary care staff to inform an intervention aimed at making online blood test results easier for patients to access and understand	171 Lucy Goddard Mind the postnatal gap: Approaches to address health equity in Postpartum Hypertension Care (SNAP2)	93 Nefyn Williams Effectiveness of a web-based cardiac rehabilitation programme for people with chronic stable angina: results from the ACTIVATE randomised controlled trial	325 Karen Nicolson The impact of adverse childhood experiences in primary care: A scoping review investigating interventions	273 Suzanne Grant Co design and delivery of a green prescribing programme for people in recovery: An ethnographic study of barriers and facilitators to access and engagement
14:10	128 Jonathan Taylor Why continuity matters: a realist explanation of attachment, alignment and accountability in general practice	322 Panna Muqit Leading with Community: Multi stakeholder experiences of community based medical education in a UK graduate entry programme (ScotGEM)	334 Josephine-L.K. Murray 'It ain't what you do, it's the way that you do it ...' Interprofessional Collaborative Practice for Multimorbidity: A Mixed Methods Study (IC4Me)	76 David O'Hagan The General Practice Quality and Outcomes Framework prevalence of Chronic Kidney disease shows no significant increase in prevalence over 10 years, using the Health Survey of England as comparator	7 Muhammad Umair Khan Regional Trends and Socioeconomic Inequalities in Antipsychotic Prescribing and Mortality in England

Agnes Blackadder Hall
Red

14:15	94 Babu Karavadra Effectiveness and acceptability of interventions to improve maternal and offspring outcomes in women with multimorbidity: a systematic review	162 Andrew Turner Real World Use of Topical Treatments in Children and Young People with Eczema - the STRIPE study	119 Iris van der Scheer Patient and carers' involvement in remote student led CONSULTations for Medical Education (CONSULT ME): a mixed methods study	45 Joe Schofield Association between chronic opioid exposure and cardiovascular disease: A systematic review and meta-analysis	64 James Larkin A case study of an Irish professional general practice society who voted to stop accepting pharmaceutical industry payments	
14:20	83 Clio Evans Implementing ThinkCan- cer! within Contemporary Primary Care: Insights from a Qualitative Study	65 Maureen E Kelly School Leaver Selection to Medicine in Ireland - A Qualitative Study of Stakeholder Perspectives	61 Laura Emery 'It's not so individualised as I hoped it would be': a qualitative analysis of the experiences of international medical graduates in UK GP training	127 Laura Gray Patient reported quality of life (QoL) measurements in adults with multiple long term conditions: A scoping review	338 Elbina Christie Antibiotic Prescribing in Out-of-Hours Primary Care in Scotland: A Multiple Methods Study	
14:25	111 Marie Ann Mae En Wong Family Orientation in Family Medicine: a scoping review	246 Greg Irving Multiple Long Term Conditions and Health and Social Care Utilisation Among People with a History of Imprisonment: A Retrospective Population Based Study	6 Brian Wang Widening Participation for Workforce Sustainability: Inspiring Future Doctors for Primary Care	213 Ian Porter Models of Care for Multiple Long Term Conditions (MLTC): Research Priority Setting	151 Pranjal Pandey How GLP 1RA Use May Reshape Weight Management: A Narrative Review	
14:30 - 15:00	Refreshment break SAPC Ambassadors' Reception					
15:00 - 16:20	Parallel session 6					
15:00	Red - (Medical Building) Workforce, Roles & Service Models	Orange - (Medical Building) Continuity, Care Coordination & Primary-Secondary Interface	Yellow - (Medical Building) Access, Equity & Inclusion	Green - (Medical Building) Digital Health, AI & Data-Driven Primary Care	Blue - (Gateway) Multimorbidity & Complex Care	Pink - (Gateway) WORKSHOP 6A
15:00	339 Conor McCann "Waiting Poorly" for Hip and Knee Arthroplasty: Health Deterioration, Functional Decline and An Emerging Role for Primary Care in Managing Surgical Delay - Findings from the National Multicentre WAIT-DATA Study	22 Rachel Roskvist Redesigning a general practice, community health and rural medicine curriculum for medical students	150 Melissa Fielding Assisted Dying and Primary Care: A Qualitative Study of UK GPs' Views	63 Mary Steele Optimising a digital intervention to support parents/carers of children with ADHD and sleep problems	324 David Blane Family Wellbeing Workers in General Practice: evaluating a new role	210 Caroline Nicholson Leading, influencing and collaborating for health: insights from Australia, Canada and Scotland
						197 Leila Saeed Designing Team-Based Learning (TBL) to prepare medical students for the ethical challenges of General Practice

15:15	264 Sarah Alfatih Alomda Musa Building Bridges, Repairing Trust: The transformative impact of community research link workers in the Deep End	39 Eleanor Hoverd Understanding how the primary-secondary care interface works, for whom, how, why and under what circumstances, in under-served areas: a realist review	35 Joodi Mourhli Patients' Experiences of Dying at Home: Systematic Review and Interpretive Meta synthesis	53 Paul Little Randomised controlled trial of a digital intervention to protect cognitive health in adults aged 60-85 with cognitive impairment	18 Rachel Spencer Prioritising recommendations for patient directed management of post discharge GP care for older persons	
15:30	88 Hassan Awan Leading innovation in primary and community care: exploring faith leaders' role in supporting Muslim men's mental health in Wales	245 Patrick Burch Integrating Physical and Addiction Care: Evaluating 'One-Stop' Multidisciplinary Clinics in Drug and Alcohol Services?	135 Louis Levene Population and practice factors associated with changes in English general practitioner numbers in 2019-2024: a longitudinal study	288 Anna Evans In-Person General Practice Appointments and Health Service Utilisation: A Retrospective Cohort Study	307 Rachel Johnson Factors associated with treatment burden in adults aged under 65 years with multiple long-term conditions in primary care	
15:45	49 Natasha Palipane How are community care based practitioners managing frailty needs of people experiencing homelessness - systematic review	193 Zahra R Almansoor Understanding the Impact of Multiple Long-term Conditions on Advice and Guidance Referral Decisions in Primary Care: A Mixed-Methods Study	302 Olajide Popoola Barriers and Facilitators to the delivery of healthcare research in correctional facilities: A review of the literature	1 Laurie Powell Perception of teledentistry among UK general dentists	296 Samuel Warne The potential use of a socially prescribed community golf scheme implementation to inform and assist policy and practice	
15:50	154 Maryam Khan How do people of different ethnicities perceive & experience frailty? A qualitative interview study	285 Alison Porter Impact of the introduction of emergency admission risk stratification tools in primary care in England: a multiple interrupted time series analysis	263 Christiana Smith Exploring Themes in Breast Cancer Poems by Black Cancer Survivors and different Ethnicities to Enhance the Experience of Black Breast Cancer Patients	84 Akbar Ansari Compound pressures in general practice: realist appreciative inquiry	25 Andrew Knight A qualitative study of the influence of childcare on high antibiotic use in a multicultural, lower socioeconomic community	
15:55	79 Sam Quinn Improving access to and delivery of community care around death: A qualitative approach to understand the voices of patients, carers, and clinicians	167 Robin Alexander Improving Unscheduled Care for People in the Last Year of Life in Scotland	248 Hillary Collins The barriers to and facilitators of the implementation of tools developed in HIPPOCRATES for the identification, prediction and treatment of psoriatic arthritis	55 Laura Emery Exploring the literature on the award gap between international and UK medical graduates in general practice training: A scoping review	220 Rebecca Morris Working across boundaries: a conceptual understanding of the factors influencing partner collaboration in multiple long-term condition management	

16:00	60 Laura Gray Prioritising methodological uncertainties in trials for people with multiple long term conditions	32 Dr Alexia Genetay An audit of clinical monitoring for women with Turner syndrome in primary care	120 Marie Ann Mae En Wong Primary care doctors' perceptions on low-value care in Singapore: a qualitative descriptive study	293 Anna Podlasek How do we train rural practitioners worldwide? A scoping review	337 Cicely Macnamara How does pregnancy affect a woman's health: multistate modelling of morbidity trajectories for women of different parity
16:05	121 Tamsin Fisher Supporting help-seeking in farmers to prevent self-harm and suicide: a flexible approach to care	174 Irene Bossman Ethnic differences in the prevalence, incidence, trajectories and impact of multiple long term conditions	300 Sonja Hofmann Medications prescribed after an out-of-hours primary care telephone consultation in North Wales, over the course of one year	212 Greg Logan Realist Evaluation of the Scottish Sore Throat Test and Treat (S2T3) Pilot	247 Helen Atherton Factors influencing implementation of decarbonisation actions in general practice: longitudinal case study
16:10	258 Vicky Qin Behavioural epidemiology of cancer control research in primary care in South-east Asia: A scoping review of population-based surveys	287 Zoe Mainus Associations of leukaemia and chronic long term conditions: systematic review (WIP)	11 Amelie Bertrand Clinical and contextual indicators of maltreatment in disabled and non disabled children referred for Child Protection Medical Assessments in Bradford in 2023	237 Penny Ralph Process evaluation of the ACTIVATE trial: lessons from implementation challenges in a digital cardiac rehabilitation intervention	314 Mireille Captieux Does remission of type 2 diabetes matter? A qualitative study of healthcare professionals' perspectives and views about supporting remission in primary care
16:15	147 Isabel Orla Whitehead SHARP: Spiritual Health Awareness and Recommendations in Primary Care Training	157 Penny Xanthopoulos Clinician views on employing a novel patient pre-consultation tool to elicit cancer symptoms in primary care appointments: qualitative interviews	234 Melissa Fielding Between Ideals and Practice: A Qualitative Study of GP Involvement in PEoLC	141 Benjamin Owusu Using Human-Computer Interaction (HCI) Methods to Inform Machine Learning Models in Heart-Failure Care: a stakeholder engagement process	
16:30 - 17:15	12th Helen Lester Memorial Lecture Speaker: Prof Richard Byng Title: How can primary care respond to the 'mental health crisis'? Chair: Dr Panna Muqit				
18:30 - 01:00	Conference drinks reception, dinner and dance (Pre-booked tickets only) <i>Old Course Hotel</i>				

DAY 3: FRIDAY 26TH JUNE

08:00	Registration opens						
08:30 - 08:35	Welcome to day 3 Prof Colin McCowan						
08:35 - 09:15	Award Winners Session <ul style="list-style-type: none"> SAPC Doctoral prize - Emilie Couchman Title: <i>Rethinking Continuity: A Doctoral Journey Through a Mesothelioma Lens</i> OECR Academic General Practitioner - Veline L'Esperance Title: <i>From GP Funding to Genomics: A Journey Through Health Inequality</i> OECR Primary Care Scientist - Francesca Dakin Title: <i>Digital presences and futures: impacts of the ongoing digitalisation of UK general practice on patients and staff</i> Chair: Dr Kathryn Steven						
09:15 - 10:00	Dangerous Ideas Soap Box <ul style="list-style-type: none"> Louise Younie - <i>Retire resilience. Build flourishing spaces for healthcare</i> Caroline Mitchell & Maria Ahmed Drake - <i>Time to Ditch the Deep End</i> David Blane - <i>Some populations need more GPs than others - pretending otherwise is clinically unsafe</i> Margaret McCartney - <i>Stop doing PSA tests in asymptomatic men</i> Chair: Dr Samuel Warne						
10:00 - 10:30	Refreshment break						
10:30 - 11:35	Parallel session 7						
10:30	Red - (Medical Building) Workforce, Roles & Service Models	Orange - (Medical Building) Continuity, Care Coordination & Primary-Secondary Interface	Yellow - (Medical Building) Access, Equity & Inclusion	Green - (Medical Building) Diagnostics, Screening & Early Detection	Blue - (Gateway) Digital Health, AI & Remote Care	Pink - (Gateway) WORKSHOP 7A	Purple - (Gateway) WORKSHOP 7B
10:30	153 Robert Scully A new dawn for Irish Specialist Training in General Practice: curriculum review and redevelopment	91 Yuan Tian Developing Low Value Care Indicators for English General Practice: A Delphi Consensus Study	94 Molly Megson "We are not guinea pigs": Relational Epistemic Justice as the Future of Primary Care Research	188 Helena Painter Addressing health inequalities through social needs screening: An evaluation of a primary care intervention in North-East London	330 Alun Hughes Virtual Reality as a Complementary Tool in Community-Based Medical Education	242 Karen Wood Can you break into General Practice? Using escape rooms in research, teaching and engagement	336 Farhana Badshah Embedding Generalism in Undergraduate Medical Education: Principles to Practice
10:45	215 Angela Flynn Embedding Sustainability in Practice through Undergraduate Medical Education: ScotGEM Agents of Change Approach	77 Anna Pathmanathan Reducing health inequalities in respiratory care: insights from patients and prescribers on antibiotic use	276 Kritika Mishra What are the sociodemographic profiles, spatial distribution, and feasibility of hairdressing salons to participate in cardiovascular disease prevention in deprived areas of Lambeth? A mixed-methods mapping study	224 Kayleigh Mason Advice and Guidance versus direct referral in primary care: time to specialise? Diagnostic and management of inflammatory bowel disease, Parkinson's disease, and systemic lupus erythematosus	56 Rosie Essery Exploring young people's experiences of using the Acne Care Online intervention: qualitative process evaluation nested within a RCT		

11:00	164 Myriam Dell'Olio Making knowledge-work visible to help sustain future primary care: Optimising the implementation of evidence in routine general practice	114 Andrew W Murphy Medicines support and social prescribing to address patient priorities in multimorbidity (MIDAS): Protocol and baseline participant characteristics of a definitive, multi-arm, cluster randomised, controlled trial in Irish general practice	257 Elisabeth Yaneske Exploring the impact of patient triage on equity of access to general practice care: an ethnographic study	319 Caroline Rodgers Prospective Design of an Equitable Liver Fibrosis Case-Finding Programme Using Population-Level Risk Stratification	184 Clare Goyder 'An intimation of mortality': A qualitative exploration of the attitudes towards, and the acceptability of, screening for the early detection of heart failure
11:15	194 India Wheeler The inverse continuity law: what is known about relational continuity of care in areas of socioeconomic deprivation?	156 Lucy Frost What are GPs views on their role in home visiting in providing effective, equitable, sustainable and efficient in-hours primary care?	271 Rachel Greer Optimising Home Blood Pressure Monitoring to Identify People at Risk of Nocturnal Hypertension: a Feasibility Study	13 Dharani Yerrakalva Evaluation of the NHS active 10 walking app intervention through time-series analysis in 201,688 individuals	
11:30		179 Emily McFadden Nipple Shields to Support Breastfeeding: a segregated mixed methods systematic review and co-production of dissemination materials		341 Charlotte Woodcock A scoping review to identify inclusivity features used in digital interventions targeting physical activity for people with long-term conditions: A scoping review (UNITE-PAL study)	

Parallel session 8

	Red - (Medical Building) Workforce, Roles & Service Models	Orange - (Medical Building) Mental Health & Neurodiversity	Yellow - (Medical Building) Safety & Quality	Green - (Medical Building) Patient Perceptions and Public Involvement	Blue - (Gateway) Pedagogy
11:40	26 Zoe Edwards Barriers and facilitators to staff in primary care doing research	137 Katie Saunders Developing a novel Fire and Rescue Service-delivered intervention to support older adults with their mental health	47 James Tawse GPs' experiences of moving on from patient safety incidents: a qualitative study	335 Charlie Guy Public Contributors as Partners in Primary Care Research: Insights from FCAC Volunteers	219 Angela Flynn From Learning to Leading: Students' Early Audit Experience as a Catalyst for Collaborative Practice in Primary Care
11:45	277 Alison Porter Predicting risk of emergency admission: a qualitative study of the views and experience of primary care staff	231 Kieran Sweeney Epidemiology of mental-physical multimorbidity: Results from analysis of routine primary and secondary care data in Lothian	33 Diarmuid Quinlan "Going out on a limb, on your own" GP perspectives on safely managing acne using isotretinoin: A qualitative interview study	228 Alice Faux-Nightingale What patients need to know about Advice and Guidance: findings from the BADGER study	244 Helen Atherton Simulated primary care clinics in medical education: systematic review

11:50	327 Gabriella Clarke Understanding how asylum seeking and refugee women seek information about cervical screening: A Scoping review	97 Irene Petersen Long-Term Mental and Physical Health Outcomes of Perinatal Depression in Women: A Scoping Review	44 Ben Bowers Understanding the origins of end-of-life injectable medication patient safety incidents in the community: a mixed-methods analysis	269 Sima Berendes Leading the future of prevention: Co-designing a complex intervention to increase maternal vaccination uptake among socio-economically and ethnically diverse populations	208 Benjamin Jackson Community Longitudinal Integrated Placements in Primary Care - student experiences and patient-centredness based on analysis of written reflective assignments
11:55	123 Caroline Mitchell Realist Evaluation of Implementation of Multi-professional Advanced Practice in Primary Care (REMAP): a qualitative study to inform an Initial Programme Theory	204 Philip Stone Social problems associated with young-onset dementia	217 Dana Hegazy Optimising Hypertension Control in Patients with CHD and Stroke/TIA: A Targeted QOF-focused QIP	250 Sarah Skyrme Enhancing public contributors' involvement in health research through peer researcher roles	149 Dhruvadh Yerrakavla Teaching early-stage clinical medical students about health inequities
12:00	249 Oksana Kryshevich Understanding non-cancer outcomes after an urgent referral to upper and lower gastrointestinal and non-specific cancer symptom pathways - a systematic review	144 Ishbel Orla Whitehead ETHOS-GP: Exploring Team Health, and Occupational Spiritual health in general practice	229 Roisin Dillon Documentation and factors affecting safety-netting in records of paediatric patients attending urgent primary care: a retrospective cohort study	62 Chloe Gamlin Longshore Drift: findings from community listening workshops exploring pelvic pain and endometriosis in women experiencing coastal deprivation in South West England	81 Zoe McElhinney Exploring GPs' and GP Trainees' perceptions of their preparedness to meet women's health needs
12:05				68 Charlie Guy Good Afternoon, Good Evening, Good PPI	
12:20 - 13:05	Plenary 4 Speaker: Dr Munro Stewart Title: Sustainable healthcare Chair: Dr Margaret McCartney				
13:05 - 13:30	Prize giving and ASM 2027 preview Chair: Prof Gary Abel, SAPC Chair				
13:30	Conference close & take-away lunch				

Red

Medical Building café

KEYNOTE SPEAKERS

WEDNESDAY 24TH JUNE

13.10 – 13.50 | OPENING PLENARY (PANEL)

THE FUTURE WORKFORCE

Dr Charlotte Mason-Apps, Dr Victoria Tzortziou Brown OBE, Prof Stewart Mercer



Dr Charlotte Mason-Apps

Dr Charlotte Mason-Apps is an NIHR Academic Clinical Fellow in Primary Care at City St George's, London and a GP Specialty Trainee at Balham Park Surgery in South London. During training she has held leadership and representative roles across primary care, including as London Programme Leader for the Next Generation GP Programme, VTS Representative on the Sutton LMC Committee, and Regional Ambassador for the RCGP Junior International Committee.

Charlotte's research currently spans academic primary care workforce development, reproductive health and fertility, and performing arts medicine.



Dr Victoria Tzortziou Brown OBE

Professor Victoria Tzortziou Brown, OBE, is Chair of the Royal College of General Practitioners Council and Professor of Primary Care and Health Policy. She has served as a GP in East London for over two decades, with a career spanning frontline general practice, health and social care systems, academia, and sustained engagement with local communities.

Her work has consistently focused on innovation and system improvement. She brings together extensive clinical commissioning experience with a research portfolio. She has worked as Research and Innovation Lead for the North East London Integrated Care System, serving a population of

around two million, and has collaborated with NHS, public health, academic, and voluntary sector partners to strengthen engagement in research and innovation.

Professor Tzortziou Brown has held a number of senior leadership roles within the RCGP, including Vice Chair for External Affairs, Honorary Secretary, London Faculties Chair, and co-chair of the College's Health Inequalities Standing Group. She is a Founding Senior Fellow of the Faculty of Medical Leadership and Management and has served as a Non-Executive Director at Turning Point. In her academic role at the Wolfson Institute of Population Health, Queen Mary University of London, she undertakes health policy

KEYNOTE SPEAKERS

and systems research, with particular expertise in the design and evaluation of healthcare interventions and their impact on professional behaviour and health inequalities. She also supervises GP Academic Clinical Fellows and early-career researchers in Global Health.



Prof Stewart Mercer

Stewart Mercer is an academic GP and Professor of Primary care and multimorbidity at the University of Edinburgh. Stewart has extensively researched multimorbidity, especially in relation to deprivation where the inverse care law continues to limit what general practice can do to help reduce health inequalities. Stewart was a founding member of the Scottish Deep End project, and remains actively involved in Deep End matters. Over the last 5 years, with his team in Edinburgh, he has evaluated the 2018 Scottish GP contract including progress on Cluster working and the extension of the primary care multidisciplinary team, including social prescribing link workers.

THURSDAY 25TH JUNE

08.35 – 09.20 | PLENARY 2 (PANEL)

THE FUTURE OF MEDICAL EDUCATION IN PRIMARY CARE

Prof Joanne Protheroe, Prof Lindsey Pope, Prof Val Wass



Prof Joanne Protheroe

My research interests include decision aids/decision analysis; facilitating decision-making and self-management in general practice with a focus on long term conditions, disadvantaged groups, patient participation and health literacy.

My research is influenced by my clinical practice in inner-city Manchester, and is focused on two NHS priorities - the needs of socio-economically disadvantaged patients and the need for interventions to improve patient self-management in long-term conditions. My research has demonstrated that patients with low health literacy have difficulty in participating in their health care, resulting in poorer health. I am currently PI on an NIHR Programme grant looking at improving patient care in chronic musculoskeletal conditions.

KEYNOTE SPEAKERS



Prof Lindsey Pope

Professor Lindsey Pope is a Professor of Medical Education and Dean of Internationalisation (MVLS) at the University of Glasgow. She provides strategic leadership across undergraduate and postgraduate medical education through her roles as the Director of Community Based Medical Education within the Undergraduate Medical School and nationally as an Associate Postgraduate Dean for Academic Medicine for Scotland.

She is Specialty Adviser for General Practice to the Chief Medical Officer for Scotland and past Director of the Scottish School of Primary Care.

She is an MRCGP Examiner and RCGP AI Clinical Consultant for the SCA assessment. Alongside this, she is a GMC Education Associate, contributing to national quality assurance of medical schools and their assessments.

Her international work spans Europe, the Middle East and Asia, supporting family medicine education and MRCGP[INT] development.

Professor Pope has a broad research profile in medical education, with a particular focus on generalism, professional identity, assessment, EDI, workforce wellbeing and the clinical learning environment.



Prof Val Wass OBE

Val Wass retired as Professor of Medical Education in Primary Care at Aberdeen Medical School and from her international work on the World Organisation of Family Doctors (WONCA) Executive in October 2024. She has reached an ideal point to reflect on the entirety of her career.

She is a retired GP and privileged to have worked for 40+ years across a range of UK practices of varying demographics. Simultaneously, she developed a career in medical education completing a PhD in the Netherlands at Maastricht University and undertaking roles in undergraduate and postgraduate institutions nationally and internationally.

She has increasingly championed the importance of generalist learning in Primary Care. As Dean of a new School of Medicine at Keele University (2009-2015) she was fortunate to lead a more community based curriculum before retiring to expand in international education consultancy roles. As a result, she has worked extensively across the UK and in more than fifty countries. In 2016 she chaired for Health Education England the report on careers for GP in medical schools, "By Choice Not by Chance".

Awards include the RCGP William Pickles and RCGP President's International Medals and the ASME Gold Medal for an outstanding contribution to medical education. In the 2015 New Year's Honours she received the royal honour of Officer of the Order of the British Empire (OBE).

KEYNOTE SPEAKERS

THE 12TH HELEN LESTER MEMORIAL LECTURE

16:30 – 17:15

HOW CAN PRIMARY CARE RESPOND TO THE 'MENTAL HEALTH CRISIS'?



Prof Richard Byng

Richard Byng works in Plymouth as a general practitioner at Adelaide Street Surgery and was a GPwSI in mental health in the Icebreak Team for young people (2005-2025). He is Professor in Primary Care Research at the University of Plymouth specialising in developing and evaluating care for individuals with mental health problems and complex health and social needs. His work spans policy through to primary care consultations. Increasingly he is examining whole systems approaches. He has developed innovative community based services including the Rushey Green Time Bank and collaborative care for prison leavers, and individuals with dementia and psychosis. He leads the University of Plymouth Community and Primary Care Research Centre and is Deputy Director of the South West Peninsula ARC. He leads the development of an NIHR funded Mental Health Research Group focused on System Balance for mental health.

FRIDAY 26TH JUNE

12:20 – 13:05 | PLENARY 4

SUSTAINABLE HEALTHCARE



Dr Munro Stewart

Dr Munro is a five-session partner at Westgate Medical Practice in Dundee, and RCGP Vice Chair for Policy. Part of his college portfolio includes responsibility for research and innovation and Munro has been involved in research throughout his career, including on decarbonising healthcare, social prescribing, air pollution, and asthma.

POSTERS

19 Zainab Suad Spot Check: A Clinical Audit of Acne Management and Referrals in General Practise

23 Hazel Everitt Adapting the EmpathicO communication e-learning package for use in medical student education.

28 Katharine Wallis Older driver medical assessment: Validating a screening toolkit for use in general practice

29 Ammar Salman Insulinoma Initially Misdiagnosed as Migraine

31 Fahad Malik Standardising Memory Assessment and Dementia Care in Primary Care: A Quality Improvement Project in a local GP Surgery

86 Phuong Hua Serious Mental Illness among Minoritised Ethnic Children and Adolescents with Eczema: A Rapid Review

102 Leanne Boardman Bridging the Perioperative Gap: GP-Led Opportunities for Upstream Optimisation in High-BMI Multimorbid Arthroplasty Patients

116 Tilli Smith Incorporating patient and public involvement in evidence synthesis: Lessons learned from the UNITE-PAL scoping review

160 Dalila Marra Cultivating Relational Practice: Enhancing Communication and Compassion in Everyday Primary Care

161 Leila Saeed Scavenger Hunts to Promote Locality Orientation on Medical Student GP Placements

186 Agalya Ramanathan Systematic review of the integration and utility of prison medicine in undergraduate medical education

201 Sahan Bennett Improving Attendance for Annual Paediatric Asthma Reviews in Primary Care: A Two-Cycle Quality Improvement Project

253 Jennifer Cox Evaluation of a Structured Learning Pilot - Innovative Methods of Post-Graduate GP Training

342 Tingting Zhang Understanding health services access and use among Chinese residents: A qualitative interview study

344 James Larkin Managing conflicts-of-interest at an organisational level: A preliminary framework for healthcare organisation refusal of industry funding

345 Ishbel Henderson Physical activity interventions for preventing multiple long-term conditions in young adults with anxiety and depression: A scoping review

346 Kevin McConville The Health Informatics Centre: a Regional Safe Haven and Trusted Research Environment Enabling World-Leading Research

RCGP-SAPC Annual Elective prizewinner

349 Ishveer Sanghera Digital Transformation in London Primary Care: Evaluating Consultation Modality Shifts in an Urban GP Practice Following Triage Implementation

SOCIAL PROGRAMME

We are thrilled to present a packed social programme for SAPC ASM 2026!

SHORT TOWN TOURS

Short town tours will be provided by St Andrews Medical Student Ambassadors

Date and time: Morning of Wednesday 24th June - leaving on a regular basis from 9.30am to 11.30am

Meeting point: Outside Gateway Building



SAPC SOCIAL RUN/WALK

Route description: walk/jog/run on the magnificent West Sands Beach (from *that* Chariots of Fire scene),

Date and time: Friday 26th June at 7am

Meeting point: Outside Gateway Building

This is a great opportunity to meet other delegates. The pace will be conversational (i.e. slow and majestic) and once we are at the beach (5-6minutes) you can run/jog/walk a distance as long or short as you wish.



BEACHSIDE SAUNA EXPERIENCE

Date and time: Friday 26th June 7am-9am

Meeting point: Outside Gateway Building

Join us to walk down to the beachside sauna hut, participation will be a first come first served access for short sessions during the time slot above.



Gym Access

We have confirmed a reduced rate during the conference at the Saints Sport university gym for those staying in university accommodation. Let staff know at reception you are attending SAPC. <https://sport.wp.st-andrews.ac.uk/facilities/>



CONFERENCE INFORMATION

WIFI

BT Openzone is available to guests. Eduroam may be available via participating institutions if set up in advance.

MAIN REGISTRATION DESK

This is located in the Medical Building Lobby where, in addition to registering and asking for information, you can pre-book workshops and social activities.

LUGGAGE STORAGE

Medical Building tutorial rooms.

POSTERS

Display your poster on the designated board in the Medical and Biological Sciences Building. Please remove your poster at the end of the conference.

SPEAKER PREVIEW ROOM – MEDICAL BUILDING MEETING ROOM

If not already submitted by email, presentations should be taken to the speaker preview room a minimum of two hours before the start of the session in which you are presenting, so that they can be transferred to the appropriate session room.

CONFERENCE VOLUNTEER TEAM

We are delighted that many University of St Andrews students from across the health sciences will be attending as Student Volunteers to assist during the conference (they will be wearing red t-shirts). In addition to the Conference Committee, several University of St Andrews staff will also be supporting the event. The conference volunteer team will be on hand throughout the conference to guide you to the room you want to get to and answer general questions.

PARALLEL SESSIONS

Please could session chairs and speakers arrive at the room where your session will take place 10 minutes before the start time to meet each other and familiarise yourself with the audio-visual equipment.

ACCESSIBILITY

Information about accessibility for the Conference venue and Old Course Hotel is available by contacting the venues.

TOILETS

There are toilets available in all venues.

PHOTOGRAPHY

Photographs will be taken on all three days of the conference. Photos will be shared after the conference on the SAPC website and via social media. Please make yourself known to the photographer if you do not wish to have your photo taken.

PRESS ATTENDANCE – NOTICE TO PRESENTERS AND AUTHORS

There may be journalists attending the conference. If you do not wish your work to be reported, please state this at the beginning of your talk. You should also let the chair of the session know.

PUBLICATION OF ABSTRACTS

To view the abstracts, visit the online programme schedule.

The DOI link for a downloadable abstract booklet will be available on the conference page of the SAPC website after the event.

ATTENDANCE CERTIFICATES

If you wish to receive an attendance certificate, please complete the online conference evaluation form, which will be sent out by email after the event.

QUIET ROOM/PRAYER ROOM

A Medical Building meeting room is available for people to use as a quiet room, including for prayer

PEER REVIEWERS

This year 338 submissions were received including 307 presentation abstracts, 31 workshops and creative enquiry pieces. All abstracts were peer reviewed by two reviewers. Reviewers scored each abstract on five areas using a five-point scale. A mean score was obtained for each abstract using the scores assigned to it by each peer reviewer. The abstracts were ranked according to mean score, and this ranking was then used as a starting point for discussion about acceptance by the Scientific

Andrea Hilton
Andrew W Murphy
Angela Flynn
Anna Podlasek
Anna Zatorska
Bhautesh Jani
Carol Coupland
Carolyn Chew-Graham
Catherine Neden
Chinelo Egwu
Chris Burton
Colin McCowan
David Ohagan
Deborah McCahon
Deepthi Lavu
Harriet Quinn-Scoggins
Heather Barry
Joy McFadzean
Judith Ibison
Dunx Shrewsbury
Eduard Shantsila
Emilie Couchman

Faraz Mughal
Frank Sullivan
Gary Abel
George Freeman
Hassan Awan
Jialing Lin
Jo Butterworth
Jodie Blackadder-Weinstein
Joe Rosenthal
Judit Konya
Julie Walabyeki
Karen Nicolson
Karena Hanley
Kathryn Steven
Keith Moffat
Kevin McConville
Lloyd Hughes
Lloyd Thompson
Margaret Cupples
Margaret M McCartney
Matthew Ridd
Natalia Lewis

Nia Clendennen
Patricia Apenteng
Polly Duncan
Prof Amanda Howe
Rachel Ann Spencer
Rebecca Ann Walmsley
Rosina Cross
Rupert Payne
Salma Audi
Sam Merriel
Sam Quinn
Sam Warne
Sarah Mills
Serge Engamba
Shoba Dawson
Stella Kozmér
Steph Taylor
Stephanie Stockwell
Tamsin Fisher
Vivian R Ramsden
Willemina Rietsema
Zoe McElhinney

Programme Committee. The abstract scores dominated the Committee decision making but were not the sole criterion. The Committee also considered the alignment with conference themes, suitability for oral or poster presentation and the overall balance and fit of the programme.

The Scientific Programme Committee is indebted to the valuable contribution by our peer reviewers for their time and expertise:

CONFERENCE EXHIBITOR

NHS RESEARCH SCOTLAND (NRS) PRIMARY CARE NETWORK

Primary Care is where most people experience NHS services with at least 90% of all health contacts taking place in primary care, in GP and dental practices and pharmacies.

As part of the Scottish Chief Scientist Office (CSO) funded research infrastructure, the NRS Primary Care Network is the national network supporting research in primary care. The overall aim is to increase the amount of research relevant to patient care undertaken in a primary care setting: supporting both academic research and commercial clinical trials. The network facilitates the timely, appropriate and effective recruitment and follow-up of patients in primary care settings, covering the entire range of clinical research areas.

With funding from the Voluntary Scheme for Branded Medicines Pricing, Access and Growth (VPAG) Scheme, Scotland is currently developing several Practice Embedded Research Units (PERUs). A PERU is a host practice that has research embedded as part of their business plan with associated local practices acting as PIC sites. These PERUs are being supported by a team of Clinical Research Nurses (CRN) and Research Practitioners, integrated into daily research activity to allow practices to undertake research and for patients to participate in studies close to home.

For more information: <https://www.nhsresearchscotland.org.uk/research-areas/primary-care>

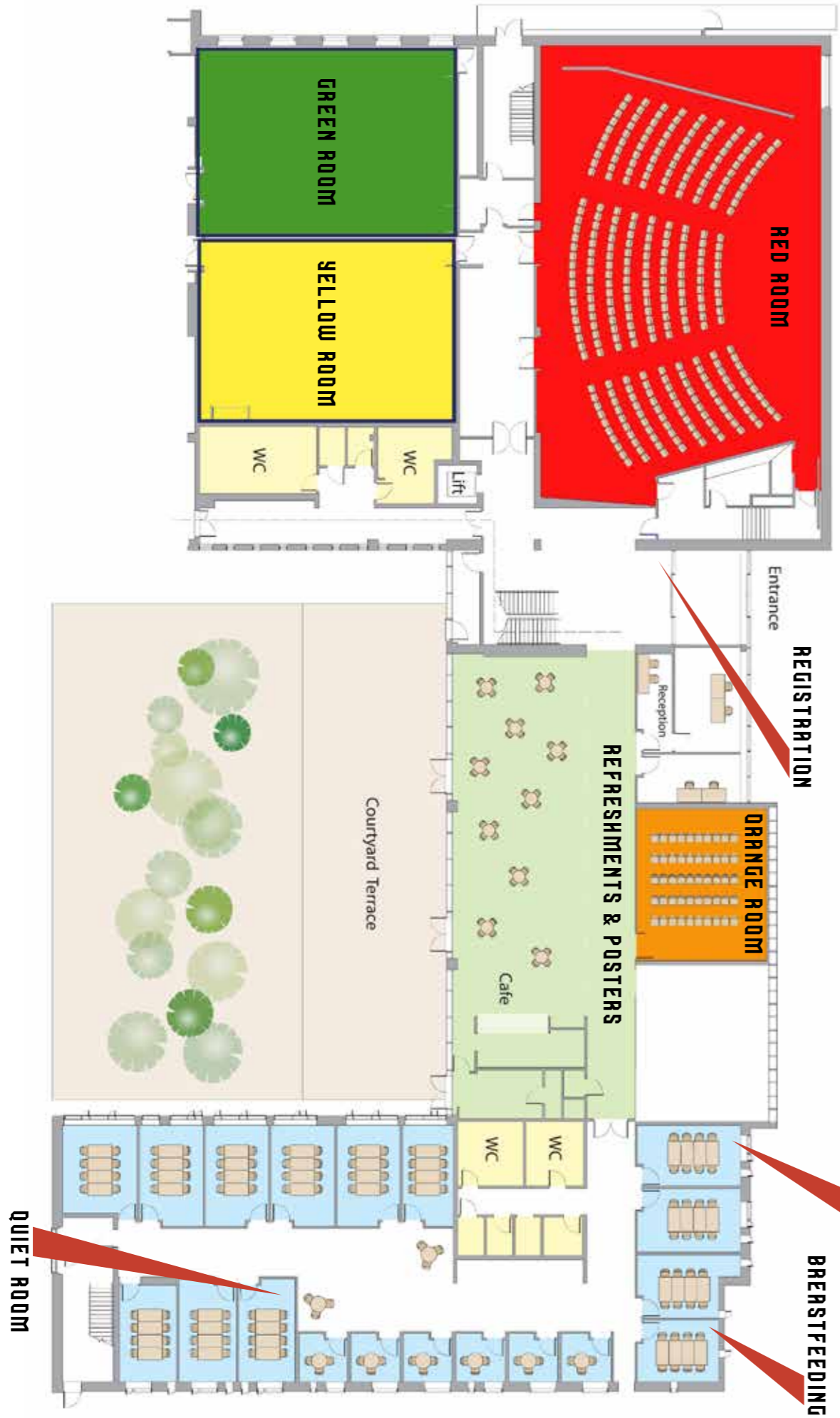

FLOOR PLAN - MEDICAL AND BIOLOGICAL SCIENCES BUILDING

FLOOR PLAN - THE GATEWAY

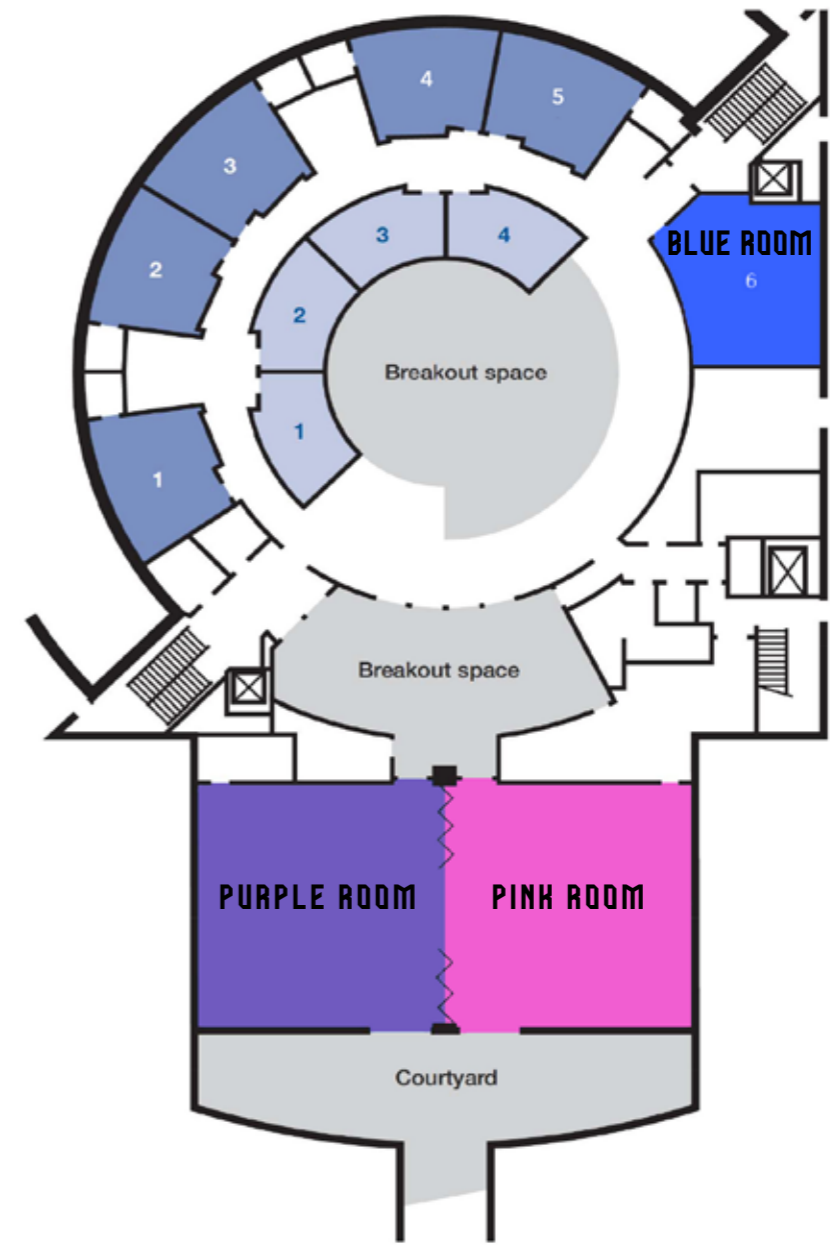

- x SEMINAR ROOMS
- x MEETING ROOMS
- BOARDROOM - TOP FLOOR

